

# Researching the History of Your New Rochelle House































2 Brookdale Place, New Rochelle



# Start Sleuthing

*First, get organized*





PROPERTY: \_\_\_\_\_

[illegible]



# Get a Bird's Eye View

Your County  
Your Community  
Your Neighborhood  
Your Home

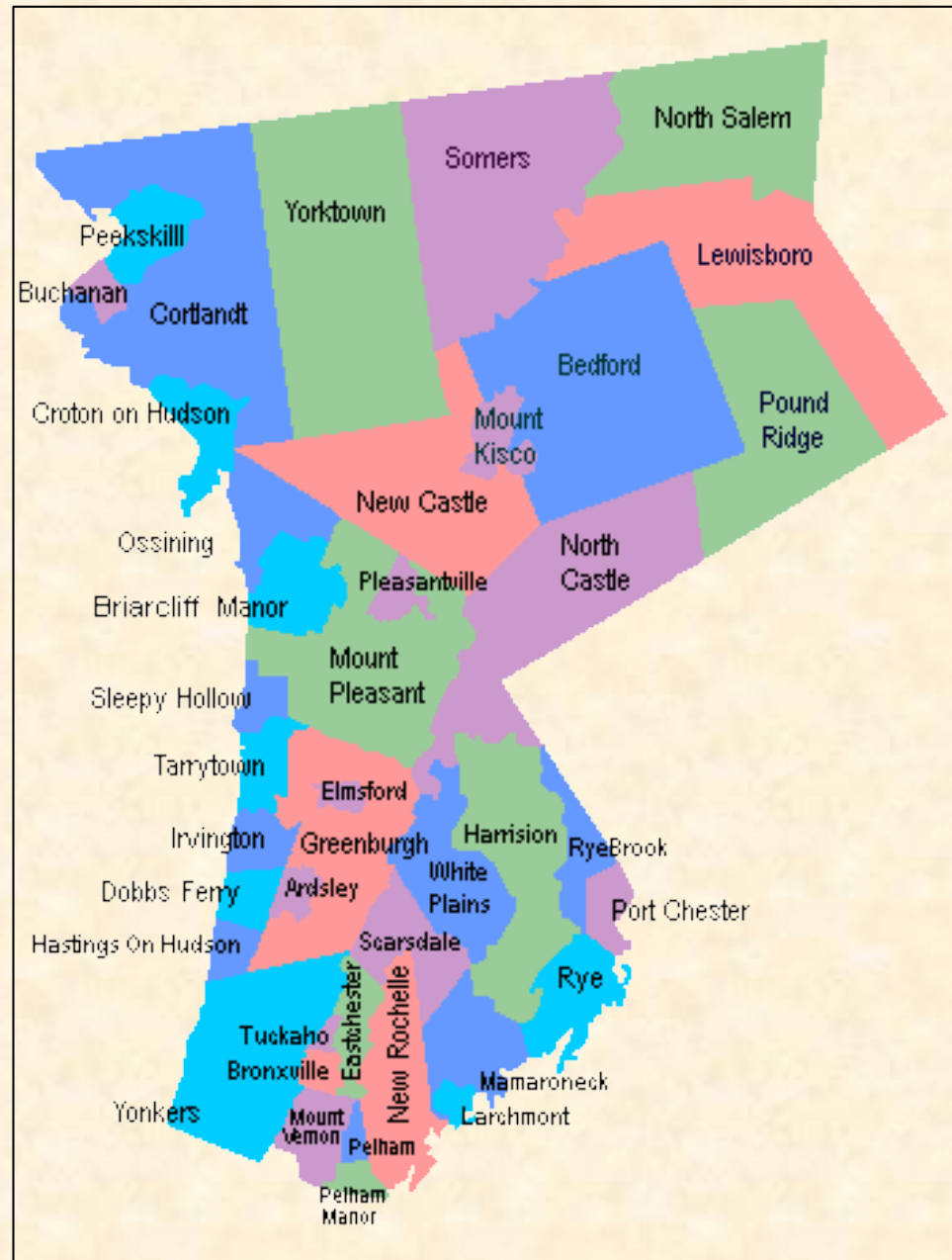





**New Rochelle Public Library**



**E. L. Doctorow Local History Room**



# Westchester County: A History

by Field Horne

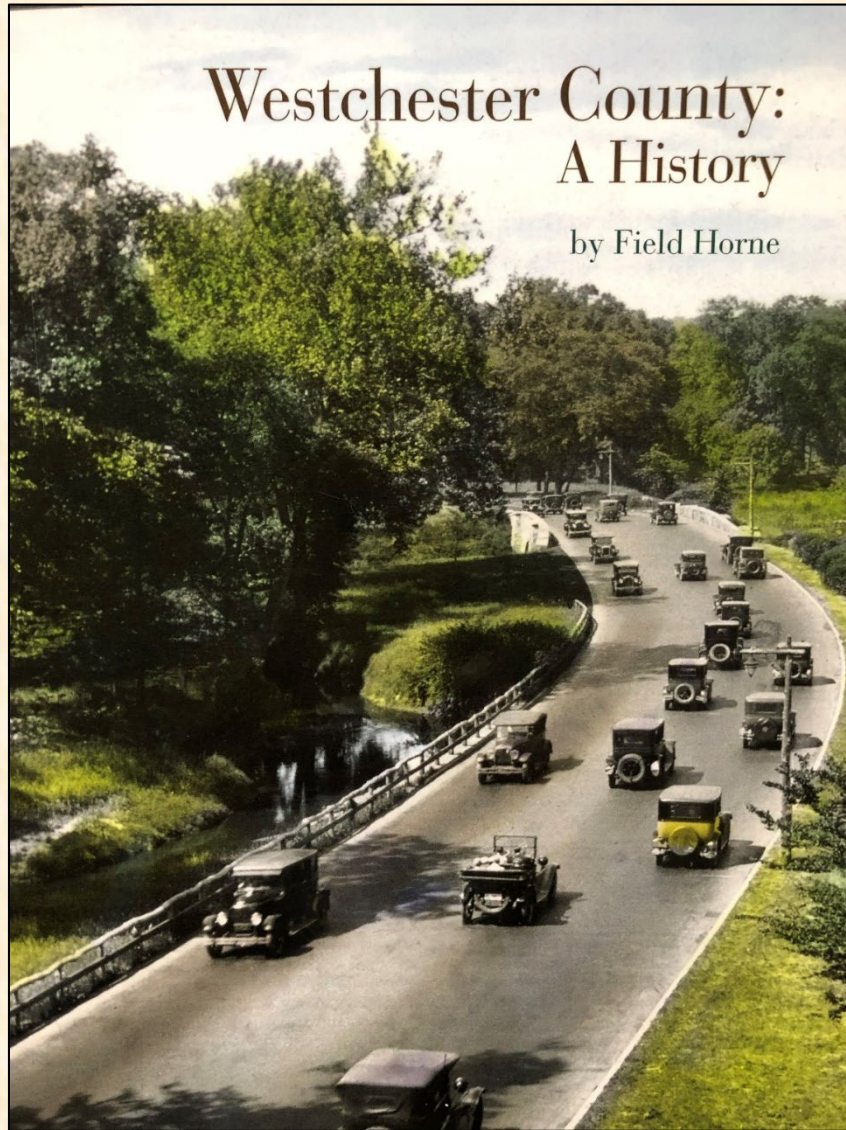

County





Community



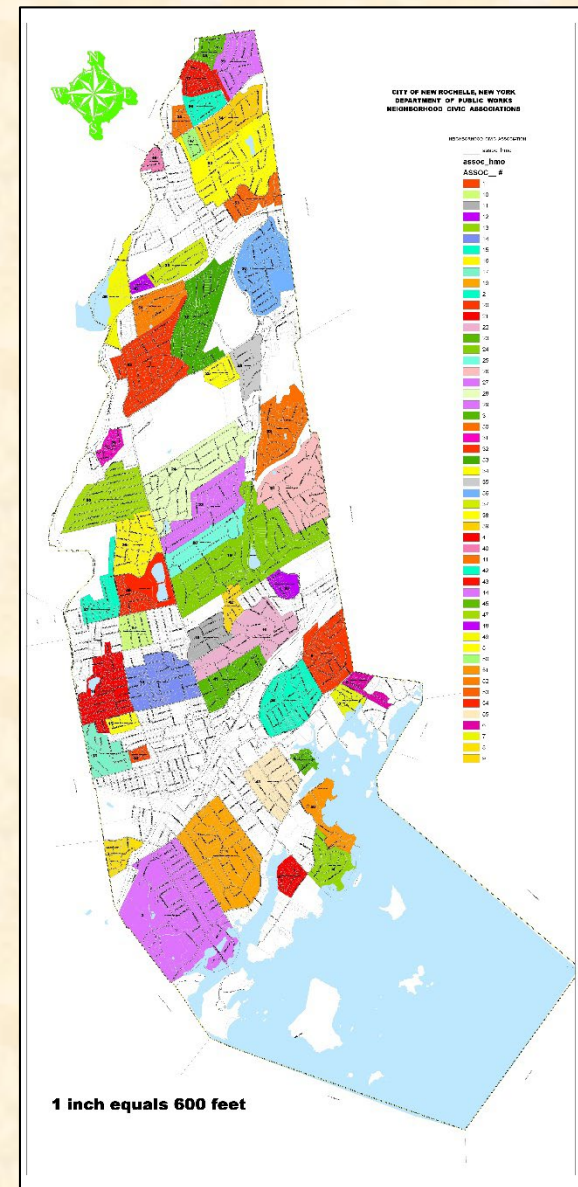

Neighborhood



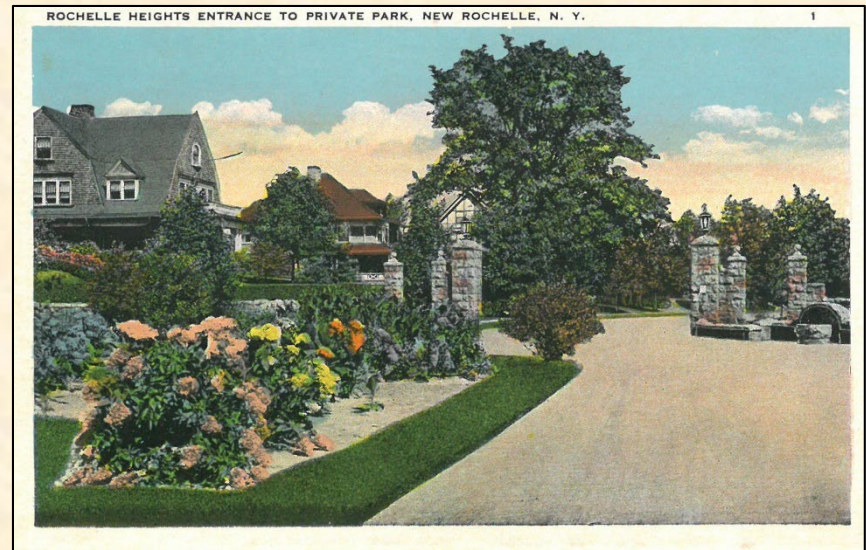

Residential Parks







# House Records: New Rochelle City Hall On-Line





## Assessor's Office City Hall 515 North Avenue

- Assessment Card
- Building Card
- Ownership Card



## Online: Property Portal

- Assessment Card
- Building Card
- Ownership Information

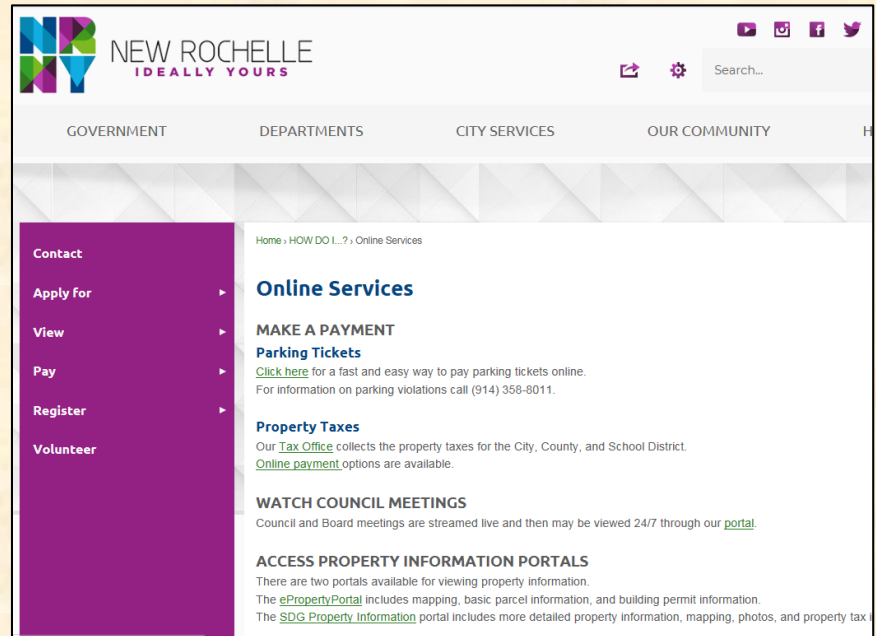



# “New Rochelle property portal”

<https://newrochelleny.com/1147/Online-Services>

The screenshot shows the New Rochelle property portal website. The header features the New Rochelle logo with the tagline "IDEALLY YOURS" and social media icons for YouTube, Instagram, Facebook, and Twitter. A search bar is located on the right. The main navigation bar includes links for GOVERNMENT, DEPARTMENTS, CITY SERVICES, and OUR COMMUNITY. A purple sidebar on the left contains links for Contact, Apply for, View, Pay, Register, and Volunteer. The main content area is titled "Online Services" and includes sections for "MAKE A PAYMENT" (with a link for Parking Tickets), "Property Taxes" (with links for Tax Office and Online payment), "WATCH COUNCIL MEETINGS", and "ACCESS PROPERTY INFORMATION PORTALS" (with links for ePropertyPortal and SDG Property Information).

**NEW ROCHELLE**  
IDEALLY YOURS

GOVERNMENT DEPARTMENTS CITY SERVICES OUR COMMUNITY

**Online Services**

**MAKE A PAYMENT**

**Parking Tickets**  
[Click here](#) for a fast and easy way to pay parking tickets online.  
For information on parking violations call (914) 358-8011.

**Property Taxes**  
Our [Tax Office](#) collects the property taxes for the City, County, and School District.  
[Online payment](#) options are available.

**WATCH COUNCIL MEETINGS**  
Council and Board meetings are streamed live and then may be viewed 24/7 through our [portal](#).

**ACCESS PROPERTY INFORMATION PORTALS**  
There are two portals available for viewing property information.  
The [ePropertyPortal](#) includes mapping, basic parcel information, and building permit information.  
The [SDG Property Information](#) portal includes more detailed property information, mapping, photos, and property tax i



## City of New Rochelle Search

4 properties match your search criteria

<b>Municipality</b>	City of New Rochelle ▼
<b>Tax ID / SBL</b>	<input type="text"/>
<b>Last Name *</b>	<input type="text"/>
<b>First Name *</b>	<input type="text"/>
<b>Street #</b>	2
<b>Street Name</b>	Brookdale Ave

[Switch to Advanced Search](#)

\* For corporate or business names, it is usually best to search in the last name field.

IMO Version 19.7 (data updated on 10/01/2021)



Residential

Property Info

Owner/Sales

Inventory

Improvements

Tax Info

Report

Comparables

Municipality of City of New Rochelle

SWIS:

551000

Tax ID:

3-840-0043

Tax Map ID / Property Data

Status:	Active	Roll Section:	Taxable
Address:	2 Brookdale Ave		
Property Class:	210 - 1 Family Res	Site Property Class:	210 - 1 Family Res
Ownership Code:			
Site:	Res 1	In Ag. District:	No
Zonning Code:	-	Bldg. Style:	Colonial
Neighborhood:	00000 -	School District:	New Rochelle
Property Description:	Built: 1909; Zone: R-1B 051616		
Total Acreage/Size:	0.28	Equalization Rate:	2021 - 2.34%
Land Assessment:	2021 - \$3,850	Total Assessment:	2021 - \$12,000
Full Market Value:	2021 - \$512,821		
Deed Book:	61039	Deed Page:	3434
Grid East:	690258	Grid North:	761941

Special Districts for 2021

Description	Units	Percent	Type	Value
RSN01-RESIDENTIAL SEWER 1	0	0%		0
RRF01-RES REFUSE FEE 1	0	0%		276
CR001-COUNTY REFUSE #1	0	0%		0
CS000-COUNTY SEWER NR DIST	0	0%		0

Land Types

No Land Types

View All Images

Photographs

No Photo Available

Pictometry Connect

Documents

- Property Record Card (Assessors)
- Property Record Card (Building)

Maps

Pin Property on GIS Map

View in Google Maps

View in Bing Maps

Map Disclaimer



Sec. 3... Block 840, Lot 43... Location... 2... BROOKDALE... AVE

FIELD SKETCH

Unexcavated portions noted.  
Overhangs and setbacks dotted in and dimensioned.  
Story heights and porches noted.

ASSESSMENTS								IMPROVEMENTS ONLY
YEAR	STORIES	CLASS	SIZE	NO. S. F.	FACTOR OF VALUE	ASSESSMENT	TOTAL ASSEMT	

1934 ASSESSMENTS					NEW BUILDINGS		
YEAR	STYS.	NO. S. F.	FACTOR OF VALUE	ASSEMT	DATE	PERMIT NO.	EST. COST

COMPUTATIONS

AREA

BASE COST

EXTRAS

DEPRECIATION

PRESENT VALUE

ASSESSOR'S NOTES		SURVEYED	DATE

GROUP			TYPE		CONDITION		SEE CARD NO. ....	REMARKS	
Key	Use	V	Key	Exterior Walls	V	Key	Exterior-Interior	V	
R1	SINGLE FAMILY	✓	1	FRAME SHINGLED ROOF SHINGLES	✓	1	EXCELLENT	✓	No. Stories <u>2 1/2</u>
R2	TWO FAMILY—UPPER AND LOWER		2	FRAME BRICK VENEER		2	GOOD	✓	No. Rooms <u>10</u>
R3	TWO FAMILY—Duplex		3	TILE OR CONC. BLK. AND STUCCO		3	FAIR		No. Baths <u>2</u>
R4	ROW-TYPE DWG'S		4	SOLID BRICK		4	POOR		No. Mails Baths
NO. OF STORES CONTAINED			5	FACE BRICK ON TILE OR CONC. BLOCK		5	VERY BAD		No. Toilet Rooms / <u>WASH</u>
									No. Chimneys <u>1</u>
									No. Fireplaces <u>1</u>
									Main Roof comp Shingle
									Flat <input type="checkbox"/> Gable <input type="checkbox"/> Gambrel

Property Record Card (Assessors)











## **County Clerk's Office**

Dr. Martin Luther King Blvd.  
White Plains, NY





County Archives and  
Westchester County Historical Society  
Westchester County Records Center  
2199 Saw Mill River Road, Elmsford, NY



New Rochelle Public Library



E. L. Doctorow Local History Room



All patrons are welcome  
to conduct research in the  
E. L. Doctorow  
Local History Room

(Patrons 16 years and younger need to be accompanied  
by an adult unless prior arrangements have been made.)

To access the room,  
please see a librarian  
at the Second Floor Desk







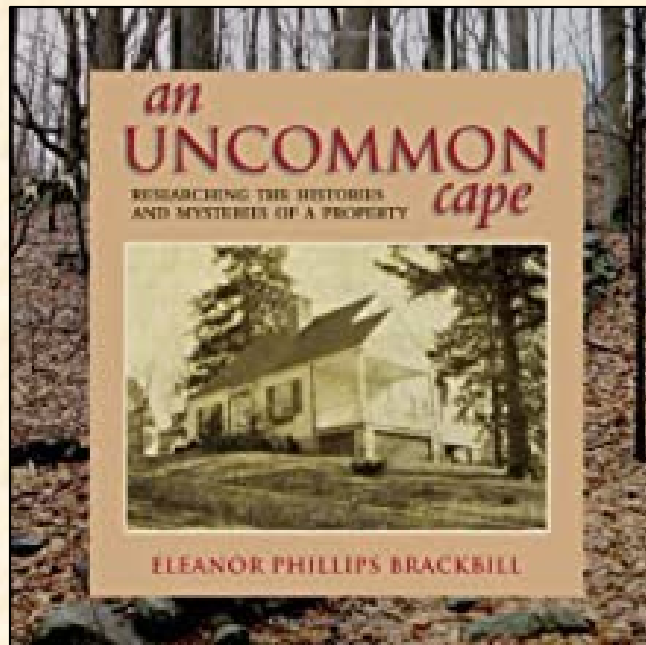

# Discovering the History of Your House

*and Your Neighborhood*



**Betsy J. Green**



# What Style is My House?

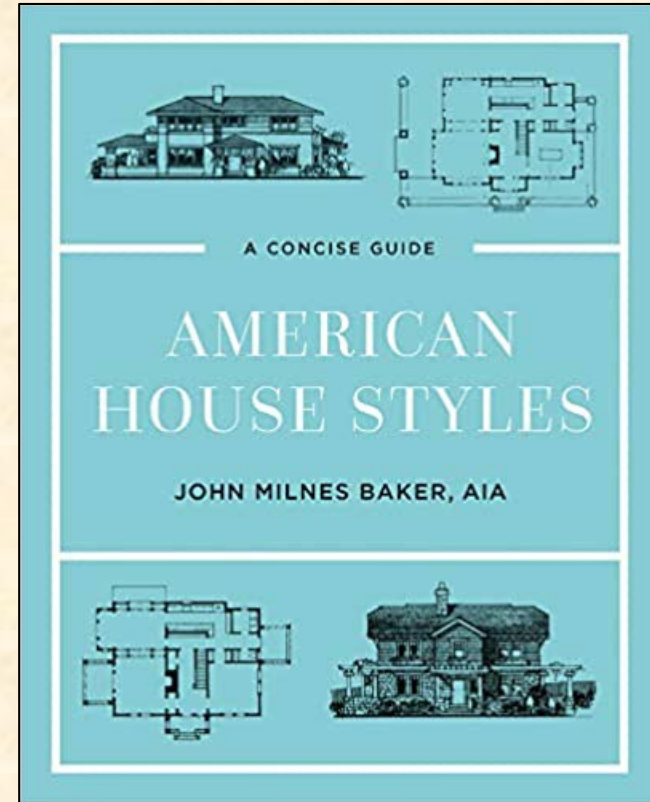
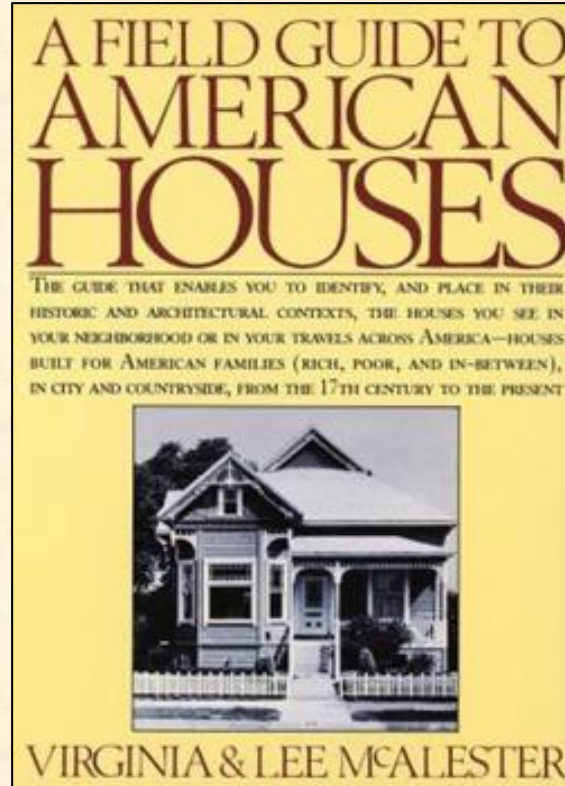
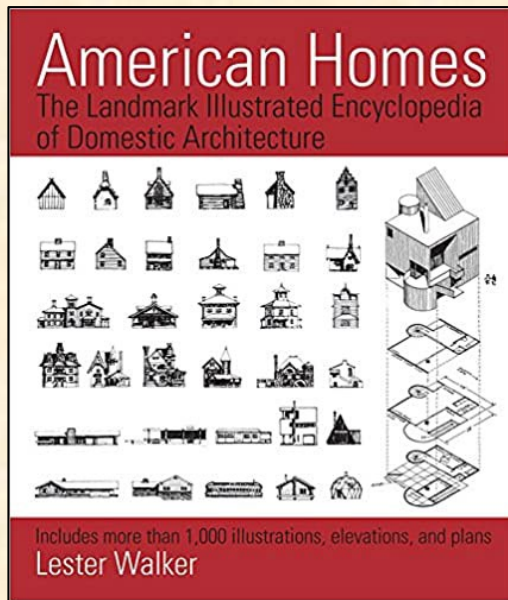

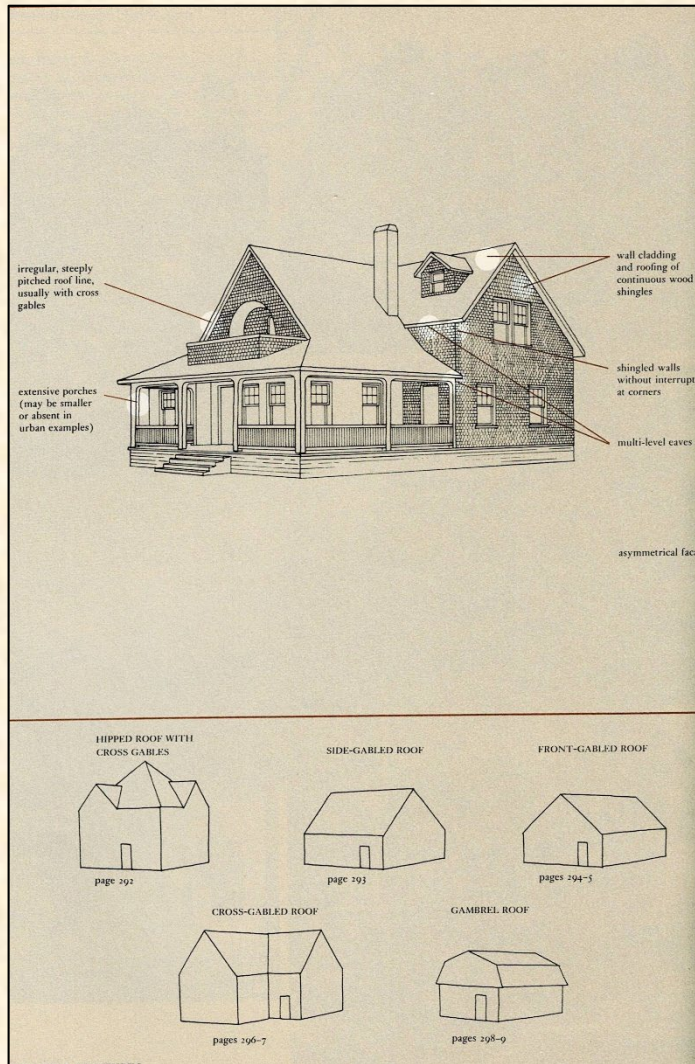

## VICTORIAN HOUSES

### Shingle

1880-1900

#### IDENTIFYING FEATURES

Wall cladding and roofing of continuous wood shingles (shingled walls may occur on second story only; original wooden roofing now replaced by composition shingles on most examples); shingled walls without interruption at corners (no corner boards); asymmetrical facade with irregular, steeply pitched roof line; roofs usually have intersecting cross gables and multi-level eaves; commonly with extensive porches (may be small or absent in urban examples).

#### PRINCIPAL SUBTYPES

Five principal subtypes can be distinguished:

**HIPPED ROOF WITH CROSS GABLES**—About 15 percent of Shingle houses have hipped roofs with lower cross gables. Asymmetrical gable arrangements, similar to the typical Queen Anne shape, are most common, but Shingle houses may also show paired, symmetrical cross gables.

**SIDE-GABLED ROOF**—About 20 percent of Shingle houses have side-gabled roofs; many of these have asymmetrically placed towers on the front facade.

**FRONT-GABLED ROOF**—About 20 percent of Shingle houses have a front gable which dominates the main facade; subordinate cross gables and towers may be added.

**CROSS-GABLED ROOF**—About 20 percent of Shingle houses have cross-gabled roofs; most are of L or T plan and have secondary cross gables and dormers intersecting the principal roof line. Subordinate hipped sections may also be added.

**GAMBREL ROOF**—About 25 percent of Shingle houses have gambrel roofs. Normally a full second story is incorporated into the steeper, lower slope of the gambrel, giving a one-story appearance. Gambrel cross gables are usually present.

#### VARIANTS AND DETAILS

Unlike most of the 19th-century styles that preceded it, the Shingle does not emphasize decorative detailing at doors, windows, cornices, porches, or on wall surfaces. Instead it aims for the effect of a complex shape enclosed within a smooth surface (the shingled exterior) which unifies the irregular outline of the house. Most variants and details are de-





### GAMBREL ROOF

Nebraska City, Nebraska; late 19th century. Morton House. The asymmetrical upper story emphasizes the gambrel form: the left half is gambreled, the right gabled.

Cincinnati, Ohio; late 19th century. The walls of these two houses are unusually large shingles.

Kansas City, Missouri; 1890. Alderson House. An uncommon three-story example.

Emporia, Kansas; late 19th century.

Wichita, Kansas; 1887.

New Haven, Connecticut; late 19th century. Note the dramatic use of windows of varying shape in the dominant front gambrel (also see Fig. 3).

Salisbury, North Carolina; late 19th century. The cantilevered balcony over the entry is unusual.

Gameville, Texas; late 19th century. Although this house has a side-gabled roof, the dominant front-facing gambrel places it in the gambrel category.

3

3

6

6

8

8

Shingle 200



# Maps of New Rochelle





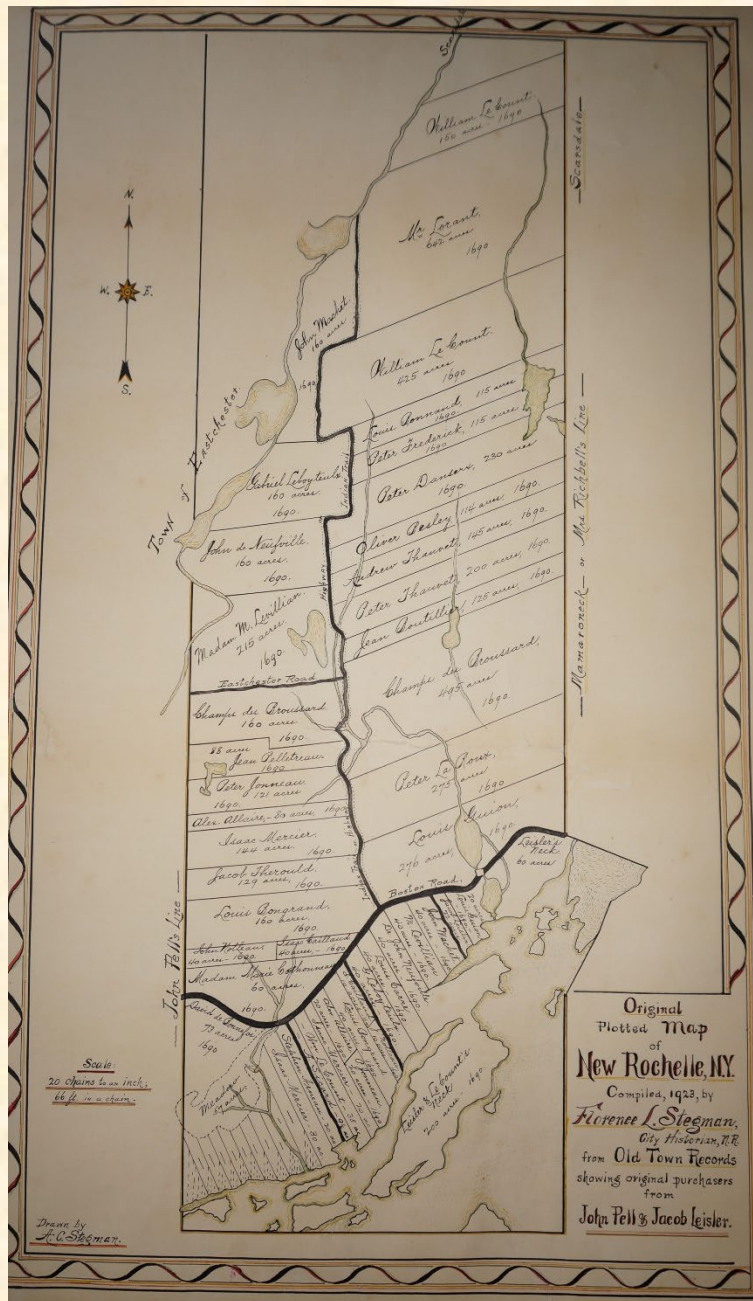





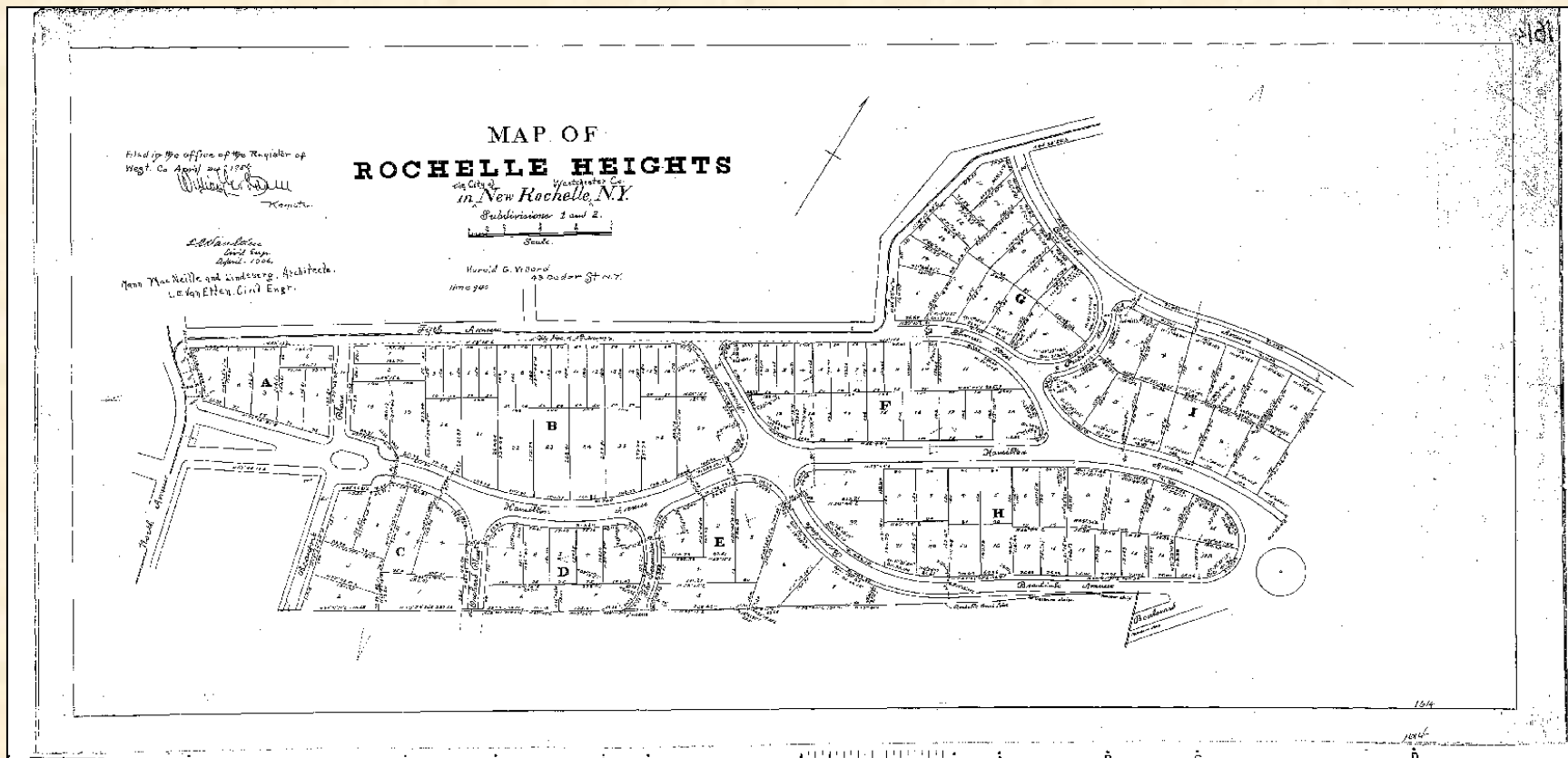

1905 Subdivision Map  
Mann, MacNeille and Lindeberg, Architects  
L. E. Van Etten, Civil Engineer





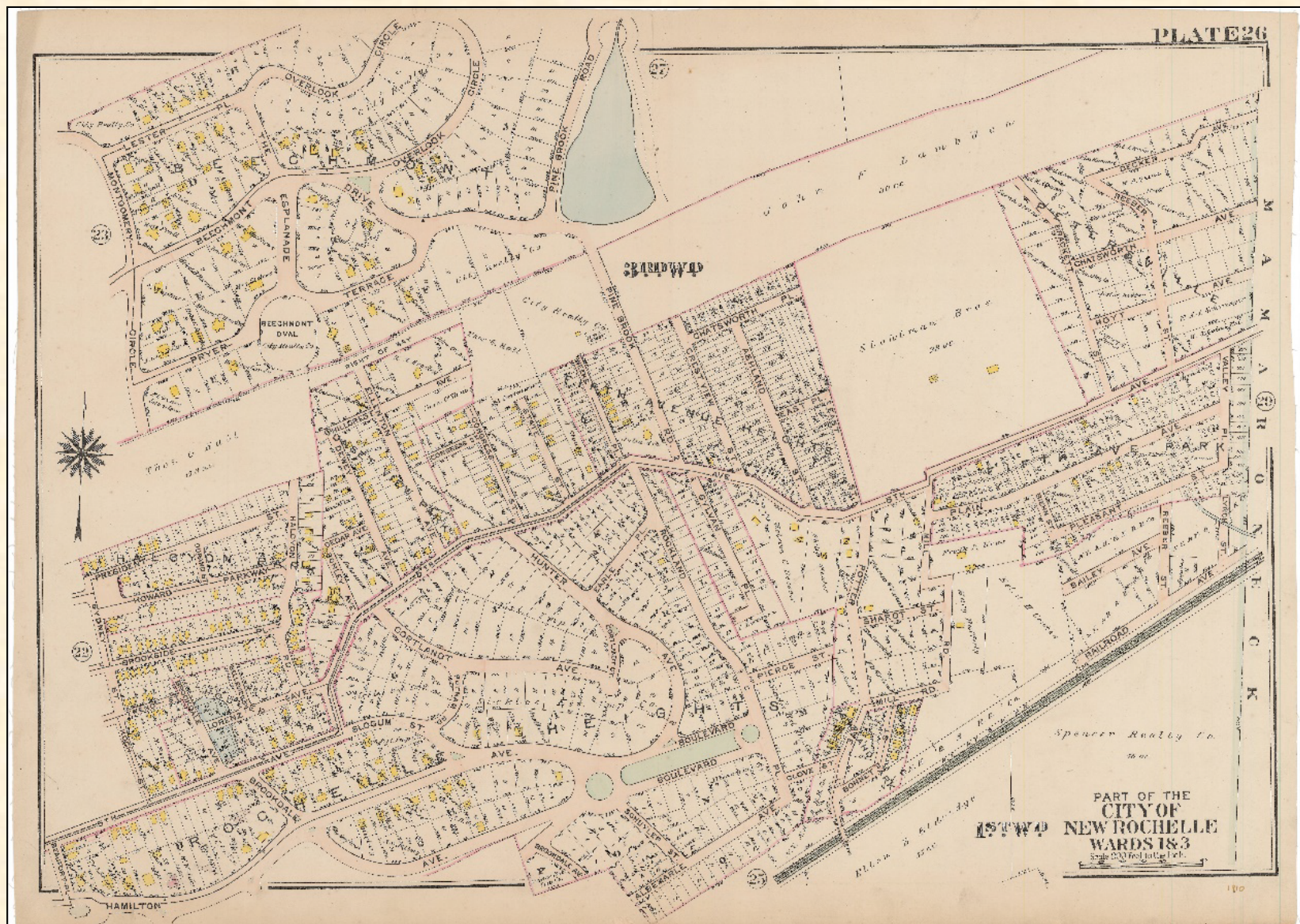









1927 G. M. Hopkins Atlas



1927 G. M. Hopkins Atlas Close-up



Who Were the People  
Who Lived in My House?

Location			19... Valuation		Section 3 Block 840 Lot 43				
Formerly Part of Block			Appt. No. Date		Block 840 Lot 43				
BUREAU OF ASSESSMENT — CITY OF NEW ROCHELLE N.Y. — OWNERSHIP RECORD									
Conveyed	Recorded	Entered	From Whom to Whom	Address	Mortgages	R. S.	Tot. Consid.	Liber	Page
				"RESTRICTIONS APPLY"					
1.509	11.22.09		Lichka Est Imp Co					1894	178
10.11.09	11.22.09		Cora A. Coffin					1894	171
6.8.21	6.14.21	2.14.22	Clonine D. Delmar						
			Briggs & Cellotab, Inc.		12,000.	8 <sup>00</sup>		2308	287
3.31.22	4.1.22	6.14.22	John H. Fuchsman		12,000.	9 <sup>00</sup>		2357	130
9.14.23	9.25.23	10.22.24	Sarah A. Cahill		12,000.	10 <sup>00</sup>		2455	115
9.14.27	9.16.27	1.9.28	Harrison Johnson & W.	2 Grosvenor St. NYC	10,000.			2797	10
1.3.42	1.20.42	4.14.42	Dowd Estates Inc	DOWD ESTATES INC 65 BROADWAY, NYC.	12,000	55 <sup>00</sup>		3977	238
10.18.44	10.24.44	12.8.44	Harrison Johnson		PAY 5000	8 <sup>25</sup>		4200	484
9.20.49	9.22.49	11.10.49	Frederick J. Kopf		PAY 10000	15 <sup>40</sup>		4782	195
11.8.55	3.12.56	6.4.56	George Jeffreys & W (Fidcl)		3500 BY 10000	19 <sup>00</sup>		5562	436
2.4.60	3.25.60	4.17.60	GEORGE, JR + RAYMOND JEFFREYS					7624	14
10.6.87	10.16.87	11.6.87	Dorothy & Allen McLean	1/2			674 169 500	8996	262
2.8.21	3.4.21	3.5.21	Vanta Holding Corp				375,000	61039	3434







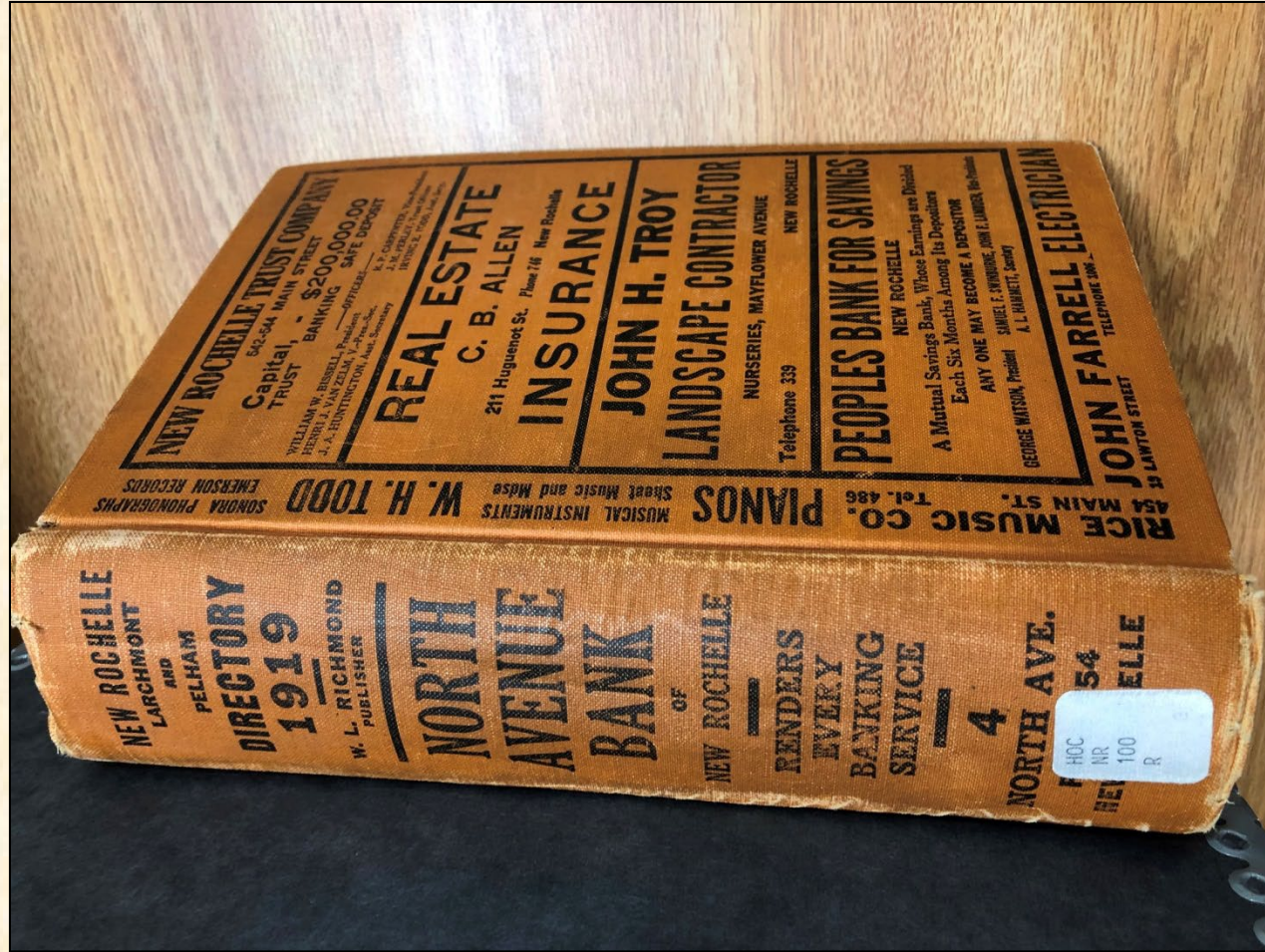

Directories





## Welcome to HeritageQuest Online at Home

City Directories  
Census Map Guide  
U.S. Indian Census Rolls

Mortality Schedules  
Agricultural and Industrial Schedules  
U.S. Freedman's Bank Record, 1861-1875

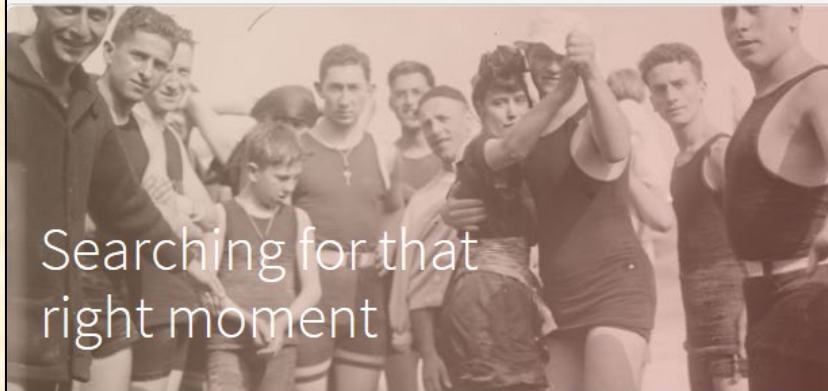

Searching for that  
right moment

We have billions of records ready to  
reveal your family's story.

[Begin Searching](#)

### US Census Records

1940 1930 1920 1910 1900  
1890 1880 1870 1860 1850  
1840 1830 1820 1810 1800  
1790

[View All](#)

### Canada Census Records

1921 1911 1901 1891 1881  
1871 1861

[View All](#)

### SEARCH US CENSUS



Find ancestors in the  
complete set of U.S. Federal

### SEARCH BOOKS



Find information on people  
and places described in over

### SEARCH REVOLUTIONARY WAR



Search selected records from

### SEARCH US OBITUARIES

JANUARY.  
1. Obituary: Dr. D. B. Cheney, an old Baptist minister of Chicago, in that city; aged 74.  
2. Obituary: Col. Floyd Clarkson, well known G. A. R. veteran, in New York; aged 68.  
Orlando B. Potter, prominent in New York circles, in New York; aged 71. William P. Earle, an old New York hotel keeper, in New York; aged 80.

Find facts from obituaries  
from the 1800's on

from 10c. to \$3000.  
To pay Dividends of  
its Earnings every Jan-  
uary and July.  
To Loan on First  
Mortgages.  
To invest in good  
Bonds which are made  
legal by the State.

**PEOPLES  
BANK FOR  
SAVINGS**

252 Huguenot St.

**QUALITY  
CARPET  
CLEANERS**

**CARPET WORK  
IN ALL ITS  
BRANCHES**

**Satisfaction  
Guaranteed**

**11 ROSE ST.  
NEW ROCHELLE**

Deierlein John, h 22 Lincoln  
Deierlein Lawrence G., clk P. O., h 22 Lincoln  
Deierlein Press, 22 Lincoln, Lawrence G. and Frank  
Deierlein, proprs  
Deierlein William, clk P. O., h 22 Lincoln  
Deitch Morris, grocer, 87 Weyman av, h do  
DeJulio Christian, h 300 Lockwood av  
DeJulio Christopher, machinist, h 33 4th  
DeJulio Leonardo, gardener, h 24 Madeleine av  
DeJulio Nicholas, plasterer, h 33 4th  
DeKlyn Charles C., physician, 7 Brookside pl, h do  
deLachau Ada G., wid Fabian, h 136 Franklin av  
de la Fuente Angel S., pres, (N. Y.), h 47 Lockwood av  
DeLallo Dominic, carpenter, h 44 Warren  
DeLamater Anna Mrs., h 21 Allard av  
DeLamater Anna, stengr, h 40 Brookside pl  
DeLamater DuBois, h 40 Brookside pl  
DeLaney Genevieve M., teacher, h 4 Howe av  
DeLaney Mary, h 14 Germania av  
de la Torre Bueno Albert, editor, (N. Y.), h 69 Guion  
DeLauretis Marco, carpenter, h 203 4th  
DeLeon Edward Edmonds, h 39 Franklin av  
DeGiudice Pasquale, saloon, 145 Washington av, h do  
DeLia Constantino, emp D. P. W., h 10 Lincoln av  
DellaBadia Nicolai, confectr, h 185 Washington av  
DellaBadia Rocco, gardener, h 185 Washington av  
Delladonna Joseph, laborer, h 20 Villis av  
Delladonna Leonardo, millhand, h 20 Villis av  
Delladonna Samuel, laborer, h 49 3d  
Della-Valle Battista, plasterer, h 220 4th  
Delmar Jule, booking agt, h 2 Brookdale av, R. H.  
DelPriora Canio, laborer, h 43 1st  
DelTorto Dominico, tailor, 228 Washington av, h 300  
Lockwood av  
DelTorto Donato, carpenter, h St. John's pl c 4th  
DeLuca Gaetano, laborer, h 12 Rosedale av  
DeLuca Pasquale, driver, h 2 Lafayette av  
deLuze Grace S., artist, (N. Y.), h 378 Pelham rd  
deLuze Louis P., civil engineer, (N. Y.), h 378 Pelham rd  
DeVecchio Giovanni, janitor, h 94 4th  
DeMaio David, chauffeur, h 280 Lockwood av  
DeMarco Alphonso, fisherman, h 26 Lafayette av  
DeMarco James, driver, h 63 2d  
DeMarco Joseph, laborer, h 74 3d  
Demarest James B., principal, (N. Y.), h 29 Meadow la  
Demarest Lulu, wid Charles W., h 191 Elm  
Demarest William W., h St. Paul pl

Delladonna Samuel, laborer, h 49 3d  
Della-Valle Battista, plasterer, h 220 4th  
Delmar Jule, booking agt, h 2 Brookdale av, R. H.  
DelPriora Canio, laborer, h 43 1st  
DelTorto Dominico, tailor, 228 Washington av, h 300  
Lockwood av



W. S. CROSBIE, Resident Manager.



# **Cameron Construction Co., Inc.**

GENERAL CONTRACTORS. Buildings Financed on Reasonable Terms

32 Railroad Ave. Phone 4226 New Rochelle

108 (1926) NEW ROCHELLE DIRECTORY

Cadwallader Wallace L (Marjory) cons eng (NY) h8 A  
gyle av  
Cady Alice V (wid H W) h4 Boulevard  
Cady Donald W phys 23 Professional bldg h4 Boulevard  
Cady Marian student h4 Boulevard  
Caffrey Wm (Bernice) art dir h207 Pelham rd  
Cahill Eliz M tchr P S h28 Park av  
Cahill Kate housekpr h166 Valley rd  
Cahill Marcia M h2 Brookdale av  
Cahill Patk H (Sara) importer (NY) h2 Brookdale av  
Cahn Sidney M (Mary) dresses (NY) h28 Trenor dr  
Cahne Wm H (Loise) broker (NY) h88 Elk av  
Cahoon Mary H tchr P S h691 Main  
Cahoon Mary P (wid Jas B) h31 Coligni av  
Caiazza Antonio (Fiorenza) carp h16 5th  
Caiazza Pasquale carp h16 5th  
Caifa Jennie h750 Pelhandale av  
Cain Albert lab h176 Drake av  
Cain Margt cook h46 Winyah av  
Cain Nannie cook h46 Winyah av  
Cain Virginia (wid Jesse) h15 Beechwood av  
Caine Milton A (Eliz) mining eng h180 Mt Joy pl  
Cairns Chas H (Fannie) clk (NY) h Oxford rd  
Caise Leo (Esther) farmer "Fair Acres" Wilnot rd  
Cake Box Tea Room (Mrs Mary A Nash) 111 Centre av  
Cake Shop (Jean M Allen Audrey Nash) catering 581 M  
Cakouros Alex pastry cook h36 Lawton  
Cakouros Geo waiter h36 Lawton  
Cakouros John 60

Cahill Kate housekpr h166 Valley rd  
Cahill Marcia M h2 Brookdale av  
Cahill Patk H (Sara) importer (NY) h2 Brookdale av

Richmond Directory 1926  
(Accessed Hard Copy - NRPL)



75	Blatsch Erhard	Corp	
79	Augustine Marcel		
81	Connelly Jas		
84	Mills Howard		
84	Immediate Anthony		
84	Witt John		
88	Scheidt Chas L		
88	Manheimer Moses J		
88	Brandenberger John		
			Coll
<b>BROOKDALE AV (Richelle Hight)</b>			
From 105 Fifth av			
1	Yule Wm H		
2	Cahill Patk H		
12	Winston Jules		
15	Diat Louis		
16	Steinau John		
			Loro
20	Reinschild Fredk C		
25	Deckinger Herbert		
27	Seney Howard I		
28	Fairweather Saml L		
28	Hepburn Saml		
29	Smith W Robt		
33	Vacant		
35	Rosett L		
37			

Richmond Directory 1926  
Reverse Section

**MASON'S MATERIALS**  
Of the Best Grades, LIME for Cultivation  
Assistance in Economy of Selection Gladly Given  
**NEW ROCHELLE COAL AND LUMBER CO.**

22 Pelham Rd., 94 North Av. Phone 1000 New Rochelle

NEW ROCHELLE CITY DIRECTORY (1930) 249

Johnson Arth S (Beatrice) bkpr New Rochelle Water Co h Norwalk Conn  
Johnson Ashley C (Helen) yacht capt r47 Franklin av  
Johnson Aug carp r33 Coligni av  
Johnson Augusta cook r201 Hamilton av  
Johnson Bernard emp Borden's h16 Hickory  
Johnson Bertel chauff r77 Oak  
Johnson Bror A (Marie) decorator (NY) h12 Parcot av  
Johnson C A pres F J Tierney Sons Inc r148 Franklin av  
Johnson C C h Wykasy Gardens apt 1G  
Johnson Carl F died Feb 22 1930 age 62  
Johnson Carl J (Alina) carp h32 Congress  
Johnson Chas (Victoria) stairldr The Anderson Star Bldg h33 Woodbury  
Johnson Chas I (Lowranar) porter h143 Washington av  
Johnson Clara r15 Beechwood av  
Johnson Clarence O dentist 280 North av R405 r McVernon  
Johnson Cokusan (Kiese) mech r11 DeWitt pl  
Johnson Edw lab h32 Mechanic  
Johnson Edw (Laura) tmstr h42 Morris  
Johnson Elbert L clk (NY) r47 Brookside pl  
Johnson Eleanor sten (NY) r28 Waizins  
Johnson Ellis Mrs mus tchr (piano) 63 Grove av r do  
Johnson Ella Mrs dom r59 Crescent av  
Johnson Ella (wid Jas) r12 DeWitt pl  
Johnson Ellen C sten Fruitable Mortgage & Title Guarantee Co r ws Weaver 1 s Quaker Ridge rd  
Johnson Elmer E Jr (Florence) ins (NY) h10 Acorn la  
Johnson Elmer S tchr (NY) r12 Parcot av  
Johnson Ethel R r32 Coligni av  
Johnson Frank auto mech Bose & Parker r71 Jackson av  
Johnson Frank clk r341 Huguenot  
Johnson Frank (Ella) meatst 47 Winyah av h do  
Johnson Frank (Pearl) moving h120 Winthrop av  
Johnson Geo putr r941 Main  
Johnson Georgia maid r680 North av  
Johnson Girard auto mech r109 Huguenot  
Johnson Goldman (Gudrun) h14 Bonney pl  
Johnson Gordon G student r11 Leonard pl  
Johnson Gustav (Sophie) eng h97 Homestead pl  
Johnson Gustav A carp contr 54 Woodbury r do  
Johnson Gustave pres Oscar Ottoson & Co Inc r N Y City  
Johnson Hannah A prac nurse 20 Garden h do  
Johnson Harold B musician r123 Winthrop av  
Johnson Harrison (Anna) reed furniture (NY) h2 Brookside av  
Johnson Harrison H student r2 Brookdale av  
Johnson Helen student r20 Eastchester rd  
Johnson Homer maintenance mn New Rochelle Hosp r16 Guilon pl  
Johnson Hugh (Betty) tinsmith r357 Pelham rd  
Johnson Isabelle W student r90 Coligni av  
Johnson J A carp r49 Woodbury  
Johnson Jack (Anna) lab h86 Peel pl  
Johnson Jas (Sara) lab h99 2d  
Johnson Jas (Dora) garage hpr h409 Huguenot  
Johnson Jas A chauff r17 Division  
Johnson Jas G (Mary E) chauff h31 DeWitt pl  
Johnson Jeremiah auto mech Taylor Cook Co r109 Huguenot  
Johnson John (Alice) auto repr 13 Weyman av h N Y City  
Johnson John (Judith) carp h46 Drake av  
Johnson John chauff r16 Hickory  
Johnson John gdnr h78 Charles  
Johnson John lab r9 Brook  
Johnson John lab r9 Jarvis ter  
Johnson John E (Irene) putr h2 Rockdale av  
Johnson John H lab Bur of Sts DPW h rear 86 Winthrop av  
Johnson JOHN J (Dora). Auto Trimming and Upholstering, Carpets and Linoleum Laid, 50-52 Rose, Tel NR 1850, h32 Rose  
Johnson Jos A (Lillian) auto mech h133 Sickles av  
Johnson Jos L mech eng (NY) r12 Rhodes  
Johnson Julia (wid Chas) h1 Plain av  
Johnson Julia B chiropodist 138 North av r Yonkers  
Johnson Junius (Emma) butler r50 Avon rd

THE  
**National  
City  
Bank  
OF  
New  
Rochelle**

Complete  
Securities  
Service  
Direct Wire  
to  
New York  
Brokers  
—  
MAIN,  
COR.  
LAWTON ST.  
PHONE 6200



**Who  
Sells  
It?**

Is  
Answered  
by the  
Classified  
Business  
Lists  
in this  
Directory

Johnson Hannah A prac nurse 20 Garden h do  
Johnson Harold B musician r123 Winthrop av  
Johnson Harrison (Anna) reed furniture (NY) h2 Brookside av  
Johnson Harrison H student r2 Brookdale av  
Johnson Helen student r20 Eastchester rd  
Johnson Homer maintenance mn New Rochelle Hosp r16 Guilon pl

Richmond Directory 1930  
(Accessed on-line Heritage Quest)



# **WALTER J. COTIER, Inc.**

## **GENERAL CONTRACTORS**

Remodelling — Alterations — Waterproofing

89 DIVISION ST.

Telephone NEW ROCHELLE 2-7165

### **Johnson**

- Carl C (Mary J) shop wkr Double Seal Ring Co h 77 Oak
- Carrie Mrs domestic h 824 Oak
- Cecil (Lenora) chauff h 176 Winyah av
- Chas lab r 124 Sickles av
- Chas (Helen L) student r 254 Pelham rd
- Chas H (Victoria A) bench hand Hubbell Hardwood Door Co h 33 Woodbury
- Charlotte B tchr Calhoun sch r 7 Clove rd
- Christine E dispatcher (NY) r 56 Halcyn ter
- Clara N student nurse New Rochelle Hosp r 15 Beechwood av
- Clarence O (Lanotte D) acct (NY) h 28 Pershing av
- Clarence O (Helen) dentist 524 North av rm 405 h 1273 do
- Clinton L r 105 Winyah av
- Co of New Rochelle, Wm W Walker mgr 301 Main
- Dani lab h 28 Lawton
- David (Able) (Unity Cleaners) h 51 Clinton av
- Dayton J civil eng (Haverstraw) r 17 Colonial pl
- DeRaffele (Carl A Johnson and Angelo DeRaffele) dining car bldrs rear 158 Main
- Dora Mrs bkpr Plunkett-Webster Lumber Co Inc r 603 Main
- Dorothy F science tchr Briarcliff Junior College r 7 Clove rd
- Edw S (Mary P) h 7 Clove rd
- Elbert L (Marion) bkpr h 48 VanGuilder av
- Eleanor domestic r 3 Allard av apt 1
- Eliz cook r 18 Muir pl
- Eliz Mrs r 123 Church
- Eliz G wid Saml M r 55A Locust av apt 6F
- Eliz L Mrs domestic r 63 Grove av
- Emanuel (Daisy) h 48 Hudson
- Eric ship clk Mallory Inc r Harrison
- Eric R (Lillian) student r 56 Halcyn ter
- Fannie May r 109 Huguenot
- Flora domestic r 290 Union av apt 13
- Frank (Pearl) beamn h 176 Winyah av
- Frank (Emma) lab h 46 Mechanic apt 3
- Fredk P test eng Ward Leonard Electric Co r 7 Clove rd
- Frisella r 133 Oak
- Geo E xdrn r 141 Rhodes
- Gladys r 17 Colonial pl
- Glover (Dorothy A) lawyer (NY) h ws Wilmot rd 10 n Fennimore rd
- Gotfred R (Nancy L) liquor store h 39 Fountain pl apt 3E
- Gottfrid (Julia) liquors 408 Main h 27 LeCount pl
- Harold B (Anne M) hairdrsr 111 Winyah av h do
- Harrison (Anna M) slsmn Wm A Klein Inc h 2 Brookdale av
- Harry F (Florence) chauff h 71 Clinton av
- Harry F (Florence E) stock clk h 56 Winyah av
- Harry L (Patricia P) (Locust Arms Restaurant) h 5 Clinton pl apt 1A
- Helen domestic h 70 Morris
- Helen May legal sec r 81 Davis av
- Helen Mrs domestic h 1 Hoyt av
- Henry (Helen) h 56 Halcyn ter
- Henry (Wilma) waiter h 42 Mechanic apt 7
- Hugh clk YMCA r 580 Main
- Idell (Royal Beauty Shop) r Pelham
- Jack waiter Hotel Osborn r 46 Prince
- Jas (Rose) chauff h 488 North av
- Jas driver r 176 Winyah av
- Jas (Esther) mgr Thomas Stewart h 120 Winthrop av

**CALL 6-9600**  
**LUXOR TAXI**

74 MECHANIC STREET

24-HOUR SERVICE

rd

- Gotfred R (Nancy L) liquor store h 39 Fountain pl apt 3E
- Gottfrid (Julia) liquors 408 Main h 27 LeCount pl
- Harold B (Anne M) hairdrsr 111 Winyah av h do
- Harrison (Anna M) slsmn Wm A Klein Inc h 2 Brookdale av
- Harry F (Florence) chauff h 71 Clinton av
- Harry F (Florence E) stock clk h 56 Winyah av



# THEODORE B. RAUL

• GENERAL INSURANCE •

TELEPHONE NE 2-0500 ANYTIME

409 NORTH AVE. • NEW ROCHELLE, N. Y.

## Johnson

- Bessie usherette RKO Proctor's Theatre r 39 Hunter av
- Betty domestic r ns Potter's la 3 e Davenport neck
- Carl S (Mary J) shop wkr Double Seal Ring Co h 77 Oak
- Carrie Mrs kitchen hlpr New Rochelle Hosp h 63 Oak
- Cecil utility mn r 110 Horton av
- Chas (Kenney) h 70 Horton av apt 6C
- Chas (Helen L) acct (NY) r 254 Pelham rd
- Chas H (Victoria A) bench hand Hubbell Hardwood Door Co h 33 Woodbury
- Charlotte B tchr Calhoun sch r 7 Clove rd
- Clara N r 15 Beechwood av
- Clarence O (Linotte D) acct (NY) h 28 Pershing av
- Clarence O (Helen) dentist 524 North av rm 405 h 1273 do apt 5E (UT)
- Co of New Rochelle operators of Howard Johnson's, Geo Welch mgr 301 Main
- Danl (Helen) hlpr Quaker Ridge Fuel & Supply Co h 38 Lawton
- David D studt r 28 Pershing av
- David M (Alice) prsr h 51 Clinton av
- Della r 81 Winthrop av apt 6E
- Della domestic r 71 Wellington av
- Donald opr Queen City Plastics Inc r 630 Oak
- Dora bkpr Plunkett-Webster Lumber Co Inc r 603 Main
- Dorothy F science tchr Briarcliff Junior College r 7 Clove rd
- E R h 35 Clinton pl apt 3J
- Edw (Dorothy A) carp appr h 20 Division S
- Ella cook r 18 Muir pl
- Ella L Mrs domestic r 63 Grove av
- Emanuel (Daisy) h 48 Hudson
- Emma domestic r 157 Bon Air av
- Eric whse mgr Mallory Inc r Harrison
- Ester Mrs ofc sec Wykagyl Country Club r Larchmont
- Everett studt r 35 Webster av
- Frank (Pearl) housemo h 176 Lincoln av
- Frank (Jennie) lab h 48 Mechanic apt 3
- Fredk P test eng r 7 Clove rd
- G Liquor Store (Gottfrid Johnson) 411 Main
- G Ralph (Nancy) h 111 Franklin av apt 4F
- Geo stm ftr John McGovern and Co Inc r Scarsdale
- Geo S gdnr Bureau of Parks r 141 Rhodes
- Gerard (Mary) driver NR Coal & Lumber Co h 3 Boulevard
- Glover (Dorothy A) twyr (NY) h ns Wilmot rd 10 n Fennimore rd
- Gottfrid (Julia) (G Johnson Liquor Store) h 27 LeCoun; pl
- Grace domestic r 141 Valley rd
- Grace Mrs domestic r 137 Lincoln av
- Harold (Lillian) porter h 70 Horton av apt 3G
- Harold B (Anne M) hairdrsr 111 Lincoln av h do
- Harrison (Anna M) adjutant Norman W Crosby Camp, Spanish War Veterans
- Harry F (Florence E) stock clk h 56 Lincoln av
- Harry L (Patricia P) restr h 5 Clinton pl apt B2
- Harty cook r 46 Prince
- Harvey mach opr Queen City Plastics Inc r 509 5th av
- Helen M legal sec r 193 Centre av
- Henry (Helen) h 56 Halcyon ter
- Henry (Wilma) waiter h 42 Mechanic apt 7
- Herbert fcty wkr r 133 Lincoln av
- Hugh mteemn YMCA r 296 Huguenot
- Idell (Royal Beauty Shop) r Pelham
- Inez Mrs h 120 Remington pl (U34)

## First Westchester National Bank of New Rochelle

491 MAIN STREET

Telephone NEw Rochelle 6-3300

Central Office: 528 NORTH AVE. — Branch Office: BRONXVILLE, N. Y.

Commercial Office: E. Y. N. E. & W. R. STATION

Wholesale Office: 1925 NORTH AVE. — Fort Slocum Facility: FORT SLOCUM, N. Y.

Member Federal Deposit Insurance Corporation

- Harold (Lillian) porter h 70 Horton av apt 3G
- Harold B (Anne M) hairdrsr 111 Lincoln av h do
- Harrison (Anna M) adjutant Norman W Crosby Camp, Spanish War Veterans
- Harry F (Florence E) stock clk h 56 Lincoln av
- Harry L (Patricia P) restr h 5 Clinton pl apt B2



# ISRAEL STREGER Inc. INSURANCE

81 Centre Ave.      Phones NE 2-6869—2-6870      New Rochelle

Koop Diane E ofc sec r 5 Anderson apt 3J  
—Wm G (Edna) musn h 5 Anderson apt 3J  
**Kopf Fredk J** eng h 2 Brookdale av  
—Henry J W (Margt) r 2 Brookdale av  
—Herbert A (Ann M) pntr h 189 Brookdale av  
Kopins Howard J (Lucella) phys 421 Huguenot rm 12 h 12 Lester pl  
—John Louis studt r 12 Lester pl  
Koplik Benj S (Helen) dentist 125 Darling av h do  
Kopp Bernard S (Wilma J) sec Mutual Moulding Co Inc h 61 Hillcrest av  
Kopper Isabelle C slwn h 79 Union  
Koppersmith L (Thos Burke) house turn 108 Union av  
Kopy Clara Mrs sls clk Kramer's Kiddies Shop r 2 Biehm  
—Paul (Clara) (Paul's Service Station) (Mamaroneck) h 2 Biehm  
Kopyscianski Jean tel opr r 450 5th av Unit 15  
Korenyi Chas (Madeline) phys h 81 Franklin av  
—Karoly interne NR Hosp r do  
Korn Chas (Jean) twyr h 76 Pinebrook rd  
—Claire B sten r 76 Pinebrook rd  
—Emmy nurse r 45 Long Vue av  
—Gustav cabtmkr h 395 North av  
—Peter real estate broker r 76 Pinebrook rd  
Korne Hortense H sten-supvr PSlucum r 60 Horton av  
Kornfeld Kurt A h 402 5th av  
Korngray Amanda domestic r 10 May apt 3  
Kornsweet Francine B ofc sec Better Built Bedding r Bronxville  
—Jack (Better Built Bedding) r Bronxville  
—Natalie Mrs ofc sec Better Built Bedding r Bronxville  
Korologos Jack h 114 Franklin av  
Kortright Margt wid Jas r 1120 North av  
Kosh Allan E (June B) whol optical slsmn h 74 Donnybrook rd  
Kosiba Walter (Madeline) gdnr h 208 Union av apt 5 and 6  
Kostner Harry (Leah) executive Columbia Pictures h 14 Avis dr  
Koskelo Wm B (Betty E) driver Neptune Stg h 40 Davenport av apt 3E  
Kosman Joan Z r 1273 North av apt 5A, Unit B2  
—Saml (Rae) atty h 1273 North av apt 5A, Unit B2  
Kossman Hanna wid Wm r 89 Faneuil pl  
Kossoff Irwins (Vivian) h 333 Lincoln av  
Kost Edgar L (Emily P) real est h 59 Chester pl  
—Marilyn E r 59 Chester pl  
Kostendieck Philomena wid Adolph r 110 Cooper dr apt 2A  
Kostrinsky Saml (Estelle) silver mfr h 22 Avis dr  
Kozzarek Victor (Angela) chf eng h 600A Pelham rd apt 2B  
Kotch Jos H (Lee) dentist h 40 Lovell rd  
Kothe Augusta H wid Albert R h 155 Centre av apt 5B  
—Gladys ofc sec Drs Smith & Smith r 45 Askins pl  
—Russell W (Gladys H) slsmn h 45 Askins pl  
—Warren G (Edith N) mtce wkr h 1 Stonelea pl apt C21  
Kotteral Jas B (Mary D) master sergt USA r 14 Lincoln  
Kothaus Irma Mrs domestic r 85 Verdun  
Kotzen Harry (Kotzen Tire Co) and pres-treas Mallory Tire & Auto Service Inc r Bronx  
—Max M (Rena M) h 156 Hamilton av  
—Tire Co (Harry Kotzen) whol tres 415 Main  
Kovach Edw M Rev lecturer Iona College  
Kovarik Helen nurse NR Hosp r 1 Howe av  
Kovats Harold A (Rose M) fcty wkr h 650 Main apt 5BB  
—Walter A (Edna) insurance adjuster 529 Main h 220 Pelham rd  
Kovin Benj (Caryl) textile converter h 27 Seacord rd  
Kozminski Peter tire mn Firestone Stores r Hastings-on-Hudson  
Kracko Erich (Selma) (Utility Maintenance Engineers) and pres Climate Instruments Corp h 5 Emerson av  
—Judy studt r 5 Emerson av  
—Selma sec-treas Climate Instruments Corp r 5 Emerson av  
Kraemer Harriet R Mrs bkpr Westchester Florists r Pelham  
Kraft Alf (Barbara) electronic tech h 57 Lockwood av  
—Barbara Mrs ofc nurse I Robt Martin r 57 Lockwood av  
—Chas C sr, gold stamper h 505 Main

Koop Diane E ofc sec r 5 Anderson apt 3J  
—Wm G (Edna) musn h 5 Anderson apt 3J  
**Kopf Fredk J** eng h 2 Brookdale av  
—Henry J W (Margt) r 2 Brookdale av  
—Herbert A (Ann M) pntr h 189 Brookdale av



# **NEW ROCHELLE FEDERAL SAVINGS AND LOAN ASSOCIATION**

Insured Savings — Mortgage Loans  
Main Office Scarsdale Office  
250 NORTH AVE., NEW ROCHELLE 24 CHASE RD., SCARSDALE

## **Jefferson**

- Tourist Home (Mrs Constance McBeth) 12 Main
- Wm H (Helen S) elec eng (NYC) h250 Barnard rd
- Jeffrey Lillian M Mrs r12 Leland av
- Wm J atndt Chris J Hagenah Texaco Station r159 Lockwood av Yonkers

**Jeffreys Geo W (Ethel) chauf Pelham Oil Co (Pelham) h2 Brookdale av**  
Jeffries Gertrude (wid Ulysses) h59 Crescent av  
Jehovah's Witnesses (See New Rochelle Co of Jehovah's Witnesses) 514

## **Main R7-8**

- Jelline Anna Mrs h262 Beechmont av
- Dani studt r262 Beechmont dr
- Mitchell (Eleanor) lawyer (NYC) h262 Beechmont av
- Jemison Duval J sanitation mn A. DPW r34 Morris
- Jenicek Anton handy mn Iona College h114 Franklin av
- Jenkins Ardella maid NR Hosp r42 Sickles av
- Belle (wid Louis) r1255 North av Bldg B apt 5K
- Cath Mrs fcty wkr American White Cross Labs Inc h rear 56 1st
- Constance domestic h61 River
- Edith garment insp (NYC) r12 Serpentine dr
- Edw (Alyce) domestic Wolfe Duberstein r310 Oxford rd
- Eileen nurse r19 Hertford
- Harry H (Helen) policeman (NYC) h12 Serpentine dr
- Hubert (Ellen) Hughie's Tavern h19 Hertford
- Jeanette M teller Natl Bank of Westchester r3 Lane Crest av
- John lab h16 Walnut
- John F (Margt M) asst mkr Sears, Roebuck & Co h110 Stonela pl
- Marcell hairdrrs Arthur's Studio of Hair Design r109 Horton av
- Marion V (Unique Beauty Parlor) h91 Union av
- Marvin r35 Chatsworth pl
- Thelma L domestic Milton H Farber r54 Holly dr
- Thos D (Virginia L) mfr rep h44 Livingston rd
- Jennette Marie C studt r29 Castle pl
- Jenney Orlo K (Charlotte L) prin Albert Leonard Jr High sch h1255 North av
- Jennings Elaine hd nurse NR Hosp h128 VanGuilder av
- Ernestine M maid Sidney Singer r82 Overlook rd
- Eug J (Adeline) insp Navy Dept (NYC) h23 Inverness rd
- Fred A (Dorothy J) shop formn Linehan Oldsmobile Co h60 VanGuilder av
- Hairdresser (Saml W Jennings) 408 North av R1
- Harold R (Rita) slsmn Fordham Motors (Bronx) h22 MtTom rd
- Jas A (Eliz K) pres James A Jennings Co Inc h146 Woodland av
- Jas A Jr (Eleanor) v-pres Jas A Jennings Co Inc h30 Otsego av
- James A Co Inc, Jas A Jennings sr, pres Jas A Jennings Jr, v-pres construction, gent bldg contrs 271 North av R412
- Josephine M (wid Wm J) h61 Eastchester rd
- Kath C nurse h1 Beaufort pl apt C4
- Marguerite A (wid John N) h15 Merton
- Mary E bkpr h130 Centre av apt 1B
- Robt W (Patricia) auto slsmn (NYC) h186 Weyman av
- Saml W (Jennings Hairdresser) r255 S 1st av MtVernon
- Wm S slsmn (NYC) r61 Eastchester rd
- Jennison Richd E (Claire F) security analyst The United Corp h169 Primrose rd Williston Park
- Jens Wm G h1255 North av Bldg C apt 1Z
- Jensen Anne domestic h1 Collini av apt 3
- Arth W (Edna W) genl sls mkr h658 Pine Brook blvd
- Bruce T r720 Pelham rd apt 1K
- Donald P (Effie) circulation mgr Citizen Register (Ossining) h7 Ronalds la
- Ernest V (Ernest and Ronald) r908 Edgewood av Pelham
- Flemming J (Virginia) slsmn IBM (NYC) h21 Davenport av apt 3B
- Fredk (Gertrude) door mn h618 Main apt 2
- Henry (Margt A) domestic Abr J Eder r150 Bon Air av
- Ingrid maid PerYennemo r72 Rose Hill av
- John C (Barbara B) acct Collins, Tuttle & Co (NYC) h2270 Palmer av apt 5L
- Laura C emp Techni Tape r4 Everett

—Wm J atndt Chris J Hagenah Texaco Station r159 Lockwood av Yonkers  
**Jeffreys Geo W (Ethel) chauf Pelham Oil Co (Pelham) h2 Brookdale av**  
**Jeffries Gertrude (wid Ulysses) h59 Crescent av**  
**Jehovah's Witnesses (See New Rochelle Co of Jehovah's Witnesses) 514**  
**Main R7-8**



**What did *My House* Look Like in Earlier Years?**





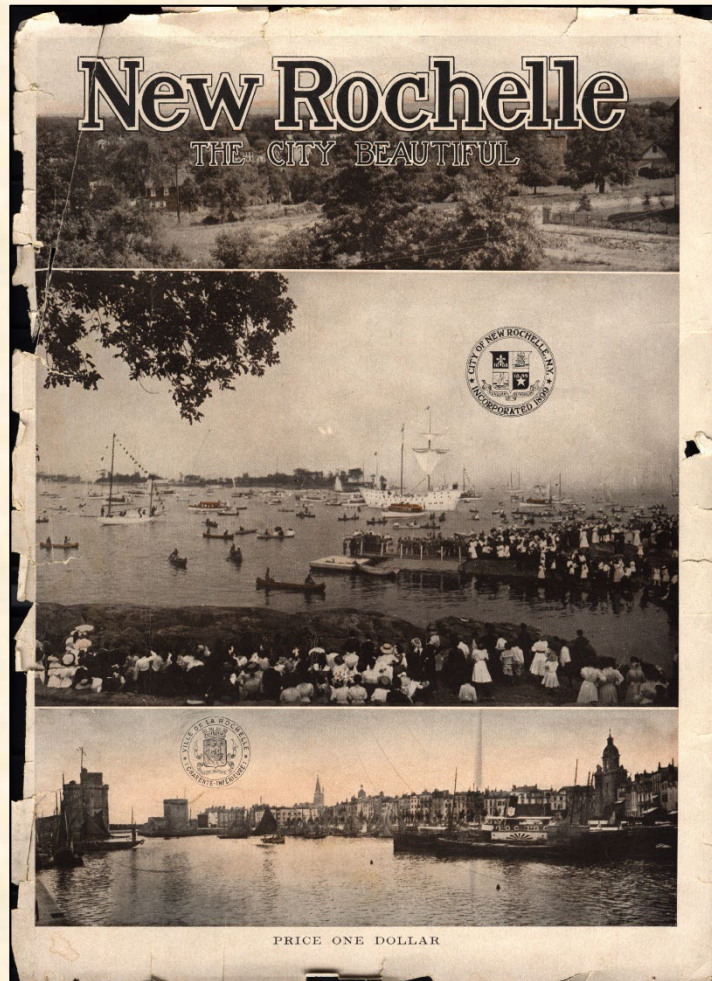

**“New Rochelle: The City Beautiful” 1912?**





RESIDENCE OF JULE DELMAR, ROCHELLE HEIGHTS



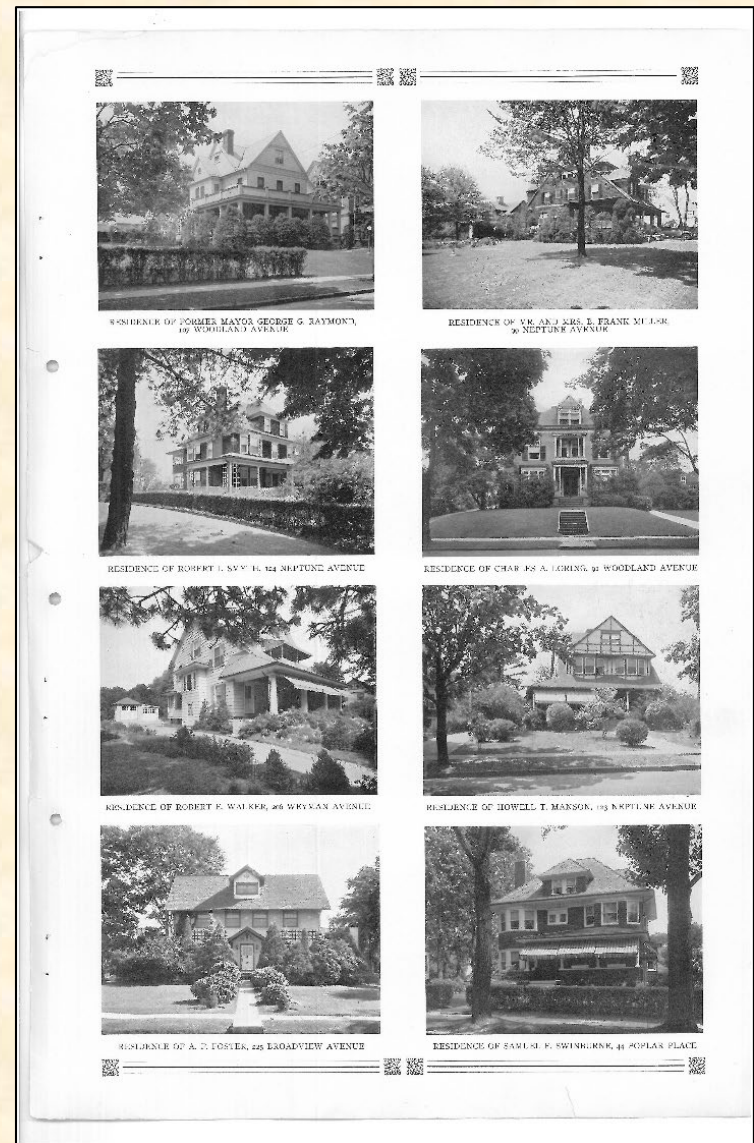
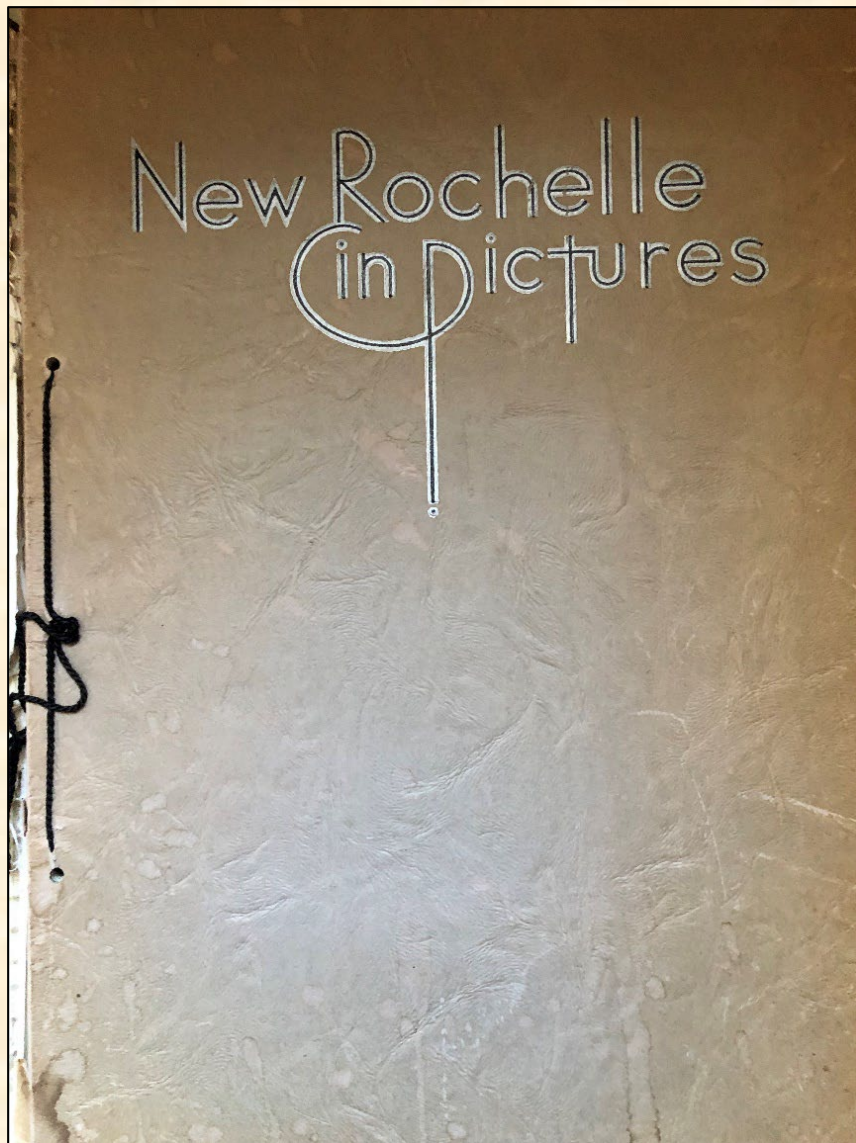

**“New Rochelle in Pictures” 1930**











## NEW ROCHELLE HISTORY

The community of New Rochelle has an extraordinarily varied long history. Founded by French Huguenots seeking religious freedom in 1688, the community was one of the New York area's premier American suburbs by 1900. Covering over 325 years, the events, people, and places are well-documented in the library's extensive Local History Collection. It is the largest repository of archival materials and resources related to the New Rochelle's heritage and contains general materials as well several specific, important collections, both offline and online.

The Local History Collection continually grows through donations from the public. It now includes over 2,500 non-circulating books, pamphlets, maps and atlases; as well as several hundred oral histories, close to 10,000 photographs and postcards, and over 55,000 reproduced newspaper and magazine clippings. Library staff and volunteers steadily work on the unending task of processing materials for online accessibility.



[COMPUTER CLASSES](#)

[ESL CLASSES](#)

[NEW ROCHELLE HISTORY](#)

[ONLINE LEARNING](#)



### MAIN LIBRARY

1 Library Plaza, New Rochelle, NY 10801  
Phone: (914) 632-7878

<b>MONDAY</b>	9 am - 8 pm
<b>TUESDAY</b>	9 am - 8 pm
<b>WEDNESDAY</b>	10 am - 6 pm
<b>THURSDAY</b>	9 am - 8 pm

▼ [THE E.L. DOCTOROW LOCAL HISTORY ROOM](#)



**The Antonio Valencia Oral History Collection** was first developed through a 1999-2000 New York State Archives and Records Administration (Documentary Heritage) grant, "Documenting the Mexican Community in New Rochelle," to record the migration of tens of thousands of people from Michoacán, Mexico to New Rochelle, beginning with Mr. Antonio Valencia in 1954.

**The Davids Island/Fort Slocum Oral History Project** was conducted in conjunction with the federal government's clean-up of the former military base located off New Rochelle, and the historic preservation mitigation. The United States Army Corps of Engineers recorded two dozen oral history interviews with former Army personnel, civilian employees, dependents and others associated with the post at one time or another from the 1920s onward.

**Voices of Reflections of Change Project** was begun in summer 2010, as part of a year-long observance of the 50<sup>th</sup> anniversary of New Rochelle's landmark desegregation Case: Taylor vs. the New Rochelle Board of Education. Three trained high school interns and the City Historian completed digital recordings of interviews with residents impacted by the case and its decision.

The current **NRPL Oral History Project**, initiated by the City Historian/NRPL Community Relations Coordinator, is an on-going project to capture the reminiscences of long-term residents. Approximately 30 additional audio cassette and digital recordings have been completed over the past 10 years.

▼ ARCHIVES CENTER

▼ ONLINE COLLECTIONS

▼ LOCAL HISTORY PRESENTATIONS

▼ FEATURED EXHIBIT: CHARLES W. DICKERSON FIFE, DRUM & BUGLE CORPS

▼ FEATURED TOPICS: WORLD WAR I

# Historic Photographs of New Rochelle

New Rochelle Public Library



[Explore the Collection >>>](#)

[Go](#)

## Scope of Collection

The photographs in this collection, approximately 10,000, date from 1850 to present and chronicle the changing face of New Rochelle. Included are rare photographs of historic houses and daily life from the 19th century, the emergence of the downtown business district from dirt lanes to a bustling commercial district, scenes of people enjoying the waterfront and observing with pride the 225th and 250th anniversaries of the city. In addition to historic views there are images of prominent writers, actors, and musicians who lived here, as well as Veterans of WW I. Most of the items come from the ...

[More](#)

## Collection Facts

**Extent:** 2250



Rochelle Heights Park, New Rochelle, N. Y.



217426

# Newspapers

Weeklies and Dailies

Microfilm: New Rochelle Public Library

On-line: Free or By Subscription



New Rochelle Paragraph (weekly)  
New Rochelle Pioneer (weekly)  
New Rochelle Star  
Evening Standard (Daily)  
Standard Star (Daily)  
Journal News  
New York Times

Microfilmed Newspapers  
Microfilm Reader

https://nyshistoricnewspapers.org/titles/places/new\_york/westchester/ Westchester County, New York

**NYS HISTORIC NEWSPAPERS**

Home About Titles **Search** Contribute Help Pages Available: 11,008,207

## Westchester County, New York

### Search All Westchester County Titles

Search  **Go** **Clear**

with the words within 5 words of each other ▼

From January ▼ 01 ▼

To December ▼ 31 ▼

### About Westchester County Titles

1 | 2

- [Chappaqua journal. \(Chappaqua, N.Y.\) 1980-current](#)
- [Chappaqua sun. \(Mt. Kisco, N.Y.\) 1954-1956](#)
- [The chronicle. \(Mount Vernon, N.Y.\) 1869-1898](#)
- [The daily press. \(White Plains, N.Y.\) 1929-????](#)
- [Eastern state journal. \(White Plains, Westchester County, N.Y.\) 1845-1918](#)
- [The Item. \(Chappaqua, N.Y.\) 1896-????](#)
- [Katonah record. \(Katonah, N.Y.\) 1913-????](#)
- [The Katonah times. \(Katonah, N.Y.\) 1878-1911](#)
- [New Castle news. \(Chappaqua, N.Y.\) 1945-????](#)
- [New Castle tribune. \(Chappaqua, N.Y.\) 1927-????](#)
- [The New Rochelle pioneer. \(New Rochelle \[N.Y.\]\) 1860-1920](#)
- [The North Westchester times : New Castle tribune. \(Mt. Kisco, N.Y.\) 1959-????](#)
- [The North Westchester times. \(Katonah, N.Y.\) 1909-1959](#)
- [Patent trader. \(Mount Kisco, N.Y.\) 1956-current](#)
- [Tarrytown daily news. \(Tarrytown, N.Y.\) 1912-1931](#)



Chappaqua Journal (Chappaqua, N.Y.) 1980-current  
Chappaqua Sun (Mt. Kisco, N.Y.) 1954-1956  
The Chronicle (Mount Vernon, N.Y.) 1869-1898  
The Daily Press (White Plains, N.Y.) 1929-????  
Eastern State Journal. (White Plains Westchester County, N.Y.) 1845-1918  
The Item (Chappaqua, N.Y.) 1896-????  
Katonah Record (Katonah, N.Y.) 1913-????  
The Katonah Times (Katonah, N.Y.) 1878-1911  
New Castle News (Chappaqua, N.Y.) 1945-????  
New Castle Tribune (Chappaqua, N.Y.) 1927-????

**The New Rochelle Pioneer (New Rochelle [N.Y.]) 1860-1920**

The North Westchester Times New Castle tribune. (Mt. Kisco, N.Y.) 1959-  
The North Westchester Times (Katonah, N.Y.) 1909-1959  
Patent Trader (Mount Kisco, N.Y.) 1956-current  
Tarrytown Daily News (Tarrytown, N.Y.) 1912-1931  
The White Plains Argus (White Plains, N.Y.) 1896-1908  
White Plains Daily Argus (White Plains, Westchester County, N.Y.) 1908-1919

# NEW ROCHELLE PIONEER

"CHARITY FOR ALL—MALICE TOWARD NONE"

ESTABLISHED EIGHTEEN HUNDRED FIFTY-NINE

VOLUME 55

DESIGNATED OFFICIAL REPUBLICAN  
COUNTY NEWSPAPER

CITY OF NEW ROCHELLE,



N. Y., JUNE 21, 1913

HENRY STREET  
BERNARD C. KINGSBURY, Proprietor

NUMBER 13

## "STARRY" NIGHT FOR FIREMEN

LOEW'S THEATRE IS CROWDED WHEN PROMINENT STAGE FOLKS AND PENSION FUND.—STELLA MAYHEW GETS A BADGE AND CUP.

One of the most enjoyable and successful benefit performances ever given in this city was that of Wednesday evening, when the Paid Firemen's Pension Fund received a substantial boost, thanks to the efforts of Stella Mayhew, Billie Taylor, Fire Commissioner George W. Floyd, Jule Delmar and other big-hearted theatrical folk who are ever ready to come forward in the cause of charity. Every one on the program, including the Fort Slocum Band, volunteered their services, and everyone in the audience volunteered hearty applause and appeared to receive the greatest satisfaction possible from their investment in a ticket.

An unusually interesting feature of the program was the presentation to Miss Mayhew by Mayor Waldorf on behalf of the paid firemen of this city, of a handsome silver, gold-lined loving cup. Miss Mayhew gracefully acknowledged the gift in a few fitting words.

### The Program.

The Fort Slocum orchestra pieces opened the program, which was as follows: Ryan and Lee, singers and dancers; Dave Ferguson in songs and recitations; The McCoy Kid, song, "That Colored Ragtime Band"; Ingilis and Redding, eccentric comedians; Sophie Barnard, from "The Man With Three Wives," who sang "Love Has a Melody All of Its Own"; Lou Anger, German Comedian, from the Winter Garden; Louise Dresser, from the Winter Garden, in songs; Sidney Grant and Charlotte Greenwood, singers and dancers; Harry Williams, the famous song-writer, in several of his own compositions; Barney Hagan and Henrietta Byron in songs; Blanche Ring, who as usual, brought down the house with the song she made famous, "Vip I Addy Aye," in which the audience joined heartily in the chorus; Andrew Mack; Stella Mayhew and Billie Taylor; Four Musical Hodges, and Bert Levy, cartoonist.

Miss Mayhew announced the performers with an original verse, and Mr. Delmar also announced. The final was an ensemble, the entire company singing "Oh, Mister Moon. Handsome bouquets of roses were given each actress, and souvenir fans were given the ladies in the audience.

Stella Mayhew Made Fire Chief. The handsome residence of Billie Taylor and her talented wife in Broadview was the scene of a jolly rather

## COUNCIL HOLDS LATE MEETING

NEW LAW ON FIREWORKS SALE—NO BATHING SUITS ON CARS; NO CHILDREN AT PUBLIC DANCES—EXPOSED FOOD MUST BE PROTECTED.

The Council on Tuesday evening held one of the longest meetings of the year, it being 11.57 when the meeting adjourned. About one hour was devoted to the reading of the minutes of the previous meeting. Several lively debates occurred during the transaction of the regular order of business. Councilman Scott met with opposition when he introduced a resolution calling for the closing of Hanford avenue, and was further opposed when he requested that the Commissioner of Streets clean off the loose stones that work to the surface of newly macadamized streets. Both propositions were carried, however.

Bathing Suits and Dance Halls. Ordinances were adopted by the Council prohibiting the wearing of bathing suits in the parks or on the streets or public conveyances, and prohibiting children under seventeen years of age from participating in dances at road houses or dance halls unless accompanied by and with the consent of their parents or guardians. A copy of the former ordinance is to be sent to the Superintendent of the Westchester Electric Railroad Company, and copies of the second are to be sent to the proprietors and managers of all the road houses and dance halls in New Rochelle.

Archibald demanded that the minutes of the previous meeting be read and approved before the regular order of business be taken up. When the motion was voted on it was carried—Cordial, Douglas and Moneuse voting against it.

The following communication to the Council was read from the Corporation Council: "In reply to your favor of the 22nd ulto, I beg to say that in my opinion Irving Place, formerly Huguenot Place, Webster avenue easterly to Faneuil Place, and Faneuil Place formerly Park View avenue, from Irving Place northerly to Eastchester Road, are public streets. \* \* \* The city may accept them, by a resolution if it so desires. \* \* \* This office does not know the width of said streets or whether they are monumented or not."

The Mayor announced his appointment of the following committee to arrange for the observance of a safe and sane Fourth of July in this city: Hon. E. J. Cordial, chairman; Rev. Robert G. McGreggor, Rev. James T. Hughes, Dr. Albert Leonard, Hon. Harry Scott, Josiah M. LeCount, W.

# Celebration Week

Sunday, June 22nd

Special services with reference to the Celebration will be conducted in all the churches.

Monday, June 23rd

Morning—Official reception of delegates and officials by the Mayor in City Hall.

Afternoon—Automobile trip for guests through the city and inspection of public buildings.

French delegates plant a tree at Hudson Park.

Evening—Public reception to guests at High School.

Tuesday, June 24th

Military, Firemen and Civic Parade at 3.00 p. m. Henry C. Perley, Grand Marshall; Charles F. Portier, Chief of Staff, and Harry Briggs, Aide. Line of march: Forming on North Avenue, at Rochelle Park, and adjacent street, thence along North Avenue to Huguenot Street, to Harrison Street, to Main Street, to Woodlawn Avenue, to Elm Street, to Centre Avenue, where parade will disband.

A public banquet will be tendered the official guests at the Wykagyl Country Club at 7.30 p. m.

Wednesday, June 25th

Unveiling and presentation of Memorial Statue of Governor Jacob Leisler, founder of New Rochelle, by Huguenot Chapter, Daughters of the Revolution, and the Huguenot Association of New Rochelle, at 2.30 p. m., at the Huguenot House Park, North Avenue.

Luncheon to guests and visitors by the Huguenot Association at 12.30 p. m.

French delegates plant a tree near Leisler Statue in Huguenot House Park on North Avenue.

Thursday, June 26th

Adrian Iselin, Jr., will entertain foreign guests in the morning with a sail on the "Adrienne," followed by luncheon at his home on Davenport Neck.

Children's Parade at 3.00 p. m. Marshall, Alexander A. Anderson; Adjutant, Carroll Winchester.

The various public schools will form in the side streets, from Lawton to Hudson Street, with their heads facing on Main Street. They will march down Main Street.

## MORE WEDDINGS FIGURE IN NEWS

MISS JANET MILLER WEDS AMID ROSES.—JOHN MERRITT TAKES HUGUENOT DESCENDANT AS BRIDE.—CROSS-SMITH NUPTIALS.

Gutterson-Miller. At the North Avenue Presbyterian Church on Tuesday afternoon, Miss Janet Miller, sister of Mrs. Robert Gardner McGreggor, and Herbert Lindley Gutterson, of New York City, were wed amid a profusion of red and white roses.

Rev. Robert Gardner McGreggor, pastor of the Church, performed the ceremony assisted by Rev. George H. Gutterson, father of the groom.

The bride was given away by her brother-in-law, Roger Butler Williams, Jr., of New York City. She was attired in a gown of white satin, with court train, covered with embroidered net. Her veil was held in place by orange blossoms and she wore pearls that had belonged to her mother. She carried a shower bouquet of brides roses and lilies of the valley. Her jewel was a gold and platinum bracelet or old design, the gift of the groom.

Her only attendant was her little niece, Miss Louise McGreggor, who wore white chiffon over white satin and carried pink flowers in a basket hat.

The best man was Wilder Gutterson, brother of the groom. The ushers were Stanley H. Tead, of Amherst College; James A. Hatch, of New York City; Logan G. Thompson, of Hamilton, Ohio, and Richard R. Williams, of Glen Ridge, N. J., all alumni of Williams College.

The guests comprised only the relatives and a few intimate friends, who were brought to New Rochelle by a special car on the New York, New Haven and Hartford Railroad. A reception was held on the porch of the parsonage.

The bride is the daughter of the late Mr. and Mrs. Martin Rumsey Miller, of Tarrytown. The groom is a graduate of Williams College, class of 1904, and Harvard Law School. He was for four years the star halfback of the Williams College football team and one of their best 100 yard sprinters, holding the College record of 10 seconds. He is the New York sales manager for the Champion Coated Paper Company.

After the honeymoon, the couple will live in Beechmont.

Merritt-Gutson. The groom is a graduate of Williams College, class of 1904, and Harvard Law School. He was for four years the star halfback of the Williams College football team and one of their best 100 yard sprinters, holding the College record of 10 seconds. He is the New York sales manager for the Champion Coated Paper Company.

After the honeymoon, the couple will live in Beechmont.

The bride is the daughter of the late Mr. and Mrs. Martin Rumsey Miller, of Tarrytown. The groom is a graduate of Williams College, class of 1904, and Harvard Law School. He was for four years the star halfback of the Williams College football team and one of their best 100 yard sprinters, holding the College record of 10 seconds. He is the New York sales manager for the Champion Coated Paper Company.

After the honeymoon, the couple will live in Beechmont.

## HISSES GREET SENATOR HEALY

COUNTY VOTERS DON'T CARE TO HEAR SENATOR EXPLAIN HIS ATTITUDE ON DIRECT PRIMARIES.—HIS ARGUMENT IMPRESSES NO ONE.

Governor Sulzer addressed an audience that filled Germania Hall to the doors on Friday evening, at a mass meeting held under the auspices of the local Progressive Party.

After addressing a big meeting in Yonkers, in which he arraigned Democratic leader Michael J. Walsh and Senator John F. Healy, the Governor spoke here to an enthusiastic gathering, among whom there was a noticeable lack of Democrats. The Governor arrived here about 10 o'clock, coming from Yonkers. He was introduced by Mayor Waldorf.

"The Governor, in part, said: 'The spirit of true Democracy is summed up in the slogan, 'Let the people rule.' They cannot rule until they obtain a successful method of nominating candidates."

The widespread demand for direct primaries originated mainly from the scandalous failure of State conventions to faithfully reflect the sentiment of the voters. Again and again candidates having strong support in State conventions have been set aside and bosses have brought forward at the last moment a dark-horse candidate and secured his nomination through skillful political manipulations.

"If it is important for minor officers to be nominated by the people, it is still more important that the people be given the power to nominate candidates for United States Senator and for Governor. That if special interests seek to control public affairs for the promotion of their selfish ends through the manipulation of party conventions, the plain people should seek to do the same thing with the same ends in their own hands the right to nominate directly these important officials."

During his address, Governor Sulzer said: "It is gratifying to see on the platform to-night A. C. Cullen, a Boie. He is an honest representative. He is able, a conscientious and a courageous Assemblyman. He had the courage in the face of opposition, to stand up and vote for the bill to give you the right to nominate your own officials."

"I wish I could say as much for the other representative," he declared, looking at Senator Healy.

Senator Healy, who was introduced by Augustus B. Deane, in part said: "You heard the Governor, by inference and innuendo and, by all the tricks of oratory, heap abuse upon me and question my motives, and try to make of me the type of fast-lane politician."



# "STARRY" NIGHT FOR FIREMEN

LOEW'S THEATRE IS CROWDED WHEN PROMINENT STAGE FOLKS AID PENSION FUND.—STELLA MAYHEW GETS A BADGE AND CUP.

One of the most enjoyable and successful benefit performances ever given in this city was that of Wednesday evening, when the Paid Firemen's Pension Fund received a substantial boost, thanks to the efforts of Stella Mayhew, Billie Taylor, Fire Commissioner George W. Floyd, Jule Delmar and other big-hearted theatrical folks who are ever ready to come forward in the cause of charity. Every one on the program, including the Fort Slocum Band, volunteered their services, and everyone in the audience volunteered hearty applause and appeared to receive the greatest satisfaction possible from their investment in a ticket.

An unusually interesting feature of the program was the presentation to Miss Mayhew by Mayor Waldorf on behalf of the paid firemen of this city, of a handsome silver, gold-lined loving cup. Miss Mayhew gracefully acknowledged the gift in a few fitting words.

## The Program.

The Fort Slocum orchestra pieces opened the program, which was as follows: Ryan and Lee, singers and dancers; Dave Ferguson in songs and recitations; The McCoy Kid, song, "That Colored Ragtime Band"; Inglis and Redding, eccentric comedians; Sophie Barnard, from "The Man With Three Wives," who sang "Love Has a Melody All of Its Own"; Lou Anger

ed with the playing of a number of selections by the Fort Slocum orchestra.

Three musical acts, furnished by the United Booking Offices under the personal interest of Jule Delmar, followed.

"Flowers, their Significance at Easter Time," was the topic of a masterful address delivered by Captain

tainment.

—The coming ball and entertainment to be given by the Police Benevolent Association at Knights of Columbus Hall on the evening of April 22, is to be an occasion of rare merit. Several noted theatrical artists of New York City, furnished through the B. F. Keith Vaudeville Exchange, under the direction of Jules Delmar, of this city, will give entertaining numbers. The entire proceeds of the affair are to be given to the treasury of the association. It is hoped that every resident who is asked to aid this worthy organization, will do his bit. By doing so a just recognition of the services of the police can be shown.

- News**papers™  
by ancestry®  
.com

TOTAL PAGES

644,884,768

## Clippings

Try 7 days free ▶

▼ Add more info



 **See papers by location**

[See all→](#)

## POW's Deny Red Leaning

Updated

**The Wichita Eagle**

Kansas bill changes who has authority regarding vaccines



Updated

Ledger-Enquirer

Fort Bessing not chosen for...

Fort Bessing not chosen for...



Clippings Files



# County Clerk's Office

Dr. Martin Luther King Boulevard  
White Plains, NY





County Archives and  
Westchester County Historical Society  
Westchester County Records Center  
2199 Saw Mill River Road, Elmsford, NY





Office of the Westchester County Clerk **Making Government Easy**  
**Westchester Records Online**

Westchester County Clerk  
Timothy C. Idoni



Welcome!  
Begin Searching



**Land Records**  
A deed, mortgage  
or other land record

[Search](#)



**Legal Records**  
A court case, judgment, lien  
or other business record

[Search](#)



**Maps**  
A map on file in our  
Clerk's office

[Search](#)

To learn more about searching our records, just roll over  
the icon for the type of information you are looking for.

Or, if you are ready to get started, just choose "Search".

Search thousands of [Westchester County Clerk](#) records  
online from your home or office

You can easily find records ranging from 18th century deeds  
to judgments entered into our Legal Division last week.

If you are a New User and would like to register to view  
images right away...[click here to register!](#)

### Returning User

Login using your User ID and Password

User ID

Password

[Forgot Your Password?](#)

[Sign In](#)

[Forgot Your User ID?](#)

### Looking for Public Viewer?

Westchester Records Online has replaced the Public  
Viewer and offers a number of enhancements including  
clear instructions and Land, Legal, Maps and Trades  
searches from one location. If you already have a User ID  
and Password for the Public Viewer, we encourage you to  
use your Public Viewer User ID and Password to login to  
Westchester Records Online and start searching.





CONSULT YOUR LAWYER BEFORE SIGNING THIS INSTRUMENT--THIS INSTRUMENT SHOULD BE USED BY LAWYERS ONLY

THIS INDEBTURE, made the 14th day of February, nineteen hundred and eighty seven  
BETWEEN George Jefferson and Raymond Jefferson, both residing at  
2 Brookdale Avenue, New Rochelle 10801 (also known as GEORGE JEFFERSON, JR  
and RAYMOND JEFFERSON in previously recorded deed)

and her husband, ALLEN KOLEAN s/o/a ALAN KOLEAN  
play of the fort porn, and Dorothy KOLEAN, residing at 37th W. 177th  
Street, BRONX, New York

purge of the accused man.

WITNESSETH, that the party of the first part, in consideration of Ten Dollars and other valuable consideration paid by the party of the second part, does hereby grant and convey unto the party of the second part, the heirs or assigns and assigns of the party of the second part forever.

All due original place, place or parcel of land within the County of Westchester and State designated by the Lot No. 17 in Block B on a certain map entitled "Map of Rochelle Heights on the City of New Rochelle, Subdivision," filed in the Office of the Clerk of the County of Westchester, Division of Land Recorder, on July 21, 1904 as Map No. 1814, bounded and described as follows:

beginning at a point on the southerly side of Fifth Avenue where the  
same is intersected by the dividing line between Lots 16 and 17 in  
Block B, as shown on said map;

on a curve to the right with a radius of 72.60 feet, a distance of 77.15 feet;

PHENCE still along the southerly side of Brookdale Avenue, 129,03  
feet to Lot No. 27 in Block B, as shown on said map;  
PHENCE in a westerly direction to

line of said Lot 27 in Block B, 126.61 in Block B, as shown on said Map;

SPACE in a northeasterly direction along the northeasterly side of said Lot 16 in Block 8, 150 feet to the southerly side of Fifth Avenue at the point of a line of

SAID PREMISES known as 2 Brookdale Avenue, New Rochelle, New York

THE FRANCHISES ARE NOT SUBJECT TO A CREDIT LINE MORTGAGE.

TOGETHER, with all right, title and interest, if any, of the party of the first part in and to any, jointly and several, claiming the above described premises to the several lots thereof; TOGETHER with the appurtenances and the same and rights of the party of the first part in and to all premises to HAVE, AND TO HOLD the several herins granted unto the party of the second part, the heirs of second and assigns of the party of the first part forever.

AND the party of the first part certifies that the party of the first part has not done or suffered anything whereby the said premises have been encumbered in any way whatever, except as aforesaid.

that the party of the first part, in compliance with Section 15 of the Lien Law, acknowledges that the party of the first part shall receive the consideration for this conveyance and will keep the right to receive such consideration as a payment of the debt for the purpose of paying the cost of the improvements and will apply the same first to payment of the cost of the improvements, before using any part of the total of the same for any other purpose.

WITNESS WHEREOF, the party of the first part has duly executed this deed the day and year first above written.

\_\_\_\_\_

Genl. Philip A.

GEORGE LEPPARD

62

W. B. DAVIS

PLATE 16 JAPANESE

17

✓

**Step 4: Enter the data—into cells A4 through E4.**

\_\_\_\_\_

تصنيف: ١٩٩٩

---

811580135

UNDER 7677 PAGE 778

CONSULT YOUR LAWYER BEFORE SIGNING THIS INSTRUMENT—THIS INSTRUMENT SHOULD BE USED BY LAWYERS ONLY.

THIS INDENTURE, made the 22nd day of December, nineteen hundred and eighty,  
 BETWEEN KEN LOEWENTRELL-BROOKDALE ESTATES, INC., 2251 Palmer  
 Avenue, New Rochelle, New York 10801.

party of the first part, and GEORGE JEFFRIES and LAURA JEFFRIES, his wife,  
 2 Brookdale Avenue, New Rochelle, New York

party of the second part,  
 WITNESSETH that the party of the first part, in consideration of Ten Dollars and other valuable consideration  
 paid by the party of the second part, do hereby grant and release unto the party of the second part, the heirs  
 or successors and assigns of the party of the second part forever,

ALL that certain plot, piece or parcel of land, with the buildings and improvements thereon erected, situate,  
 lying and being in the City of New Rochelle, County of Westchester and  
 State of New York shown and designated as Lot No. 5 on a certain  
 map entitled "Subdivision Maps of Property Belonging to Brookdale  
 Developers, Inc., situate in the City of New Rochelle, Westchester  
 County New York," made by Joseph W. Fowler, P.E., dated March 5,  
 1975 and filed in the Westchester County Clerk's Office, Division  
 of Land Records on July 25, 1979 as Map No. 20003, Being more  
 particularly described in Schedule A Annexed Hereto.



\*012561138\*

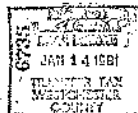

TOGETHER with all right, title and schedule, if any, of the party of the first part of, in and to any streets and  
 roads abutting the above-described premises to the center lines thereof; TOGETHER with the appurtenances  
 and all the rights and claims of the party of the first part in and to said premises; TO HAVE AND TO  
 HOLD the premises herein granted unto the party of the second part, the heirs or successors and assigns of  
 the party of the second part forever.

IN WITNESS WHEREOF, the party of the first part, in consideration of the sum of Ten Dollars and other valuable  
 consideration paid by the party of the second part, do hereby grant and release unto the party of the second part, the heirs or successors and assigns of  
 the party of the second part forever, AND the party of the first part, in compliance with Section 15 of the Lien Law, covenants that the party of  
 the first part will receive the consideration for this conveyance and will hold the right to receive such consid-  
 eration as a trust fund to be applied first for the purpose of paying the cost of the improvement and will apply  
 the same first to the payment of the cost of the improvement, before using any part of the said of the same for  
 any other purpose.

The word "party" shall be construed as if it read "parties" whenever the sense of this indenture so requires.  
 IN WITNESS WHEREOF, the party of the first part has duly executed this deed the day and year first above  
 written.

IN PRESENCE OF:

*[Signature]*

KEN LOEWENTRELL-BROOKDALE ESTATES, INC.  
 BY *[Signature]*  
 KEN LOEWENTRELL, President

FILED IN 9680 JAN 14 1981  
 00570





#031231036\*

LIB 8217 REC 564

MORTGAGE

WORDS USED OFTEN IN THIS DOCUMENT

- (A) "Mortgage." This document, which is dated December 22, 1980, will be called the "Mortgage."
- (B) "Borrower." GEORGE JEFFRIES & LAURA JEFFRIES, his wife, will sometimes be called "Borrower" and sometimes simply "I."
- (C) "Lender." FIDELITY SAVINGS CORP. will be called "Lender." Lender is a corporation or association which was formed and which exists under the laws of the State of New York. Lender's address is 105, Putnam Avenue, Hempstead, New York 11550.
- (D) "Note." The note signed by Borrower and dated December 22, 1980 will be called the "Note." The Note shows that I owe Lender SIXTY THOUSAND AND NO/100 (\$60,000.00) Dollars plus interest, which I have promised to pay in monthly payments of principal and interest and to pay in full by JANUARY 1, 2031.
- (E) "Property." The property that is described below in the section titled "Description Of The Property," will be called the "Property."

BORROWER'S TRANSFER TO LENDER OF RIGHTS IN THE PROPERTY

I mortgage, grant and convey the Property to Lender subject to the terms of this Mortgage. This means that, by signing this Mortgage, I am giving Lender those rights that are stated in this Mortgage and also those rights that the law gives to lenders who take mortgages on real property. I am giving Lender those rights to protect Lender from possible losses that might result if I fail to:

- (A) Pay all the amounts that I owe Lender as stated in the Note;
- (B) Pay, with interest, any amounts that Lender spends under this Mortgage, to protect the value of the Property and Lender's rights in the Property;
- (C) Pay, with interest, any other amounts that Lender lends to me as Future Advances under Paragraph 23 hereof; and
- (D) Keep all of my other promises and agreements under this Mortgage.

DESCRIPTION OF THE PROPERTY

I give Lender rights in the Property described in (A) through (D) below:

- (A) The property which is located at 42 Brookdale Circle, New Rochelle, New York 10801. This property is in Westchester County in the State of New York. It has the following legal description:

LEGAL DESCRIPTION IS IN THE ATTACHED SCHEDULE "A".

MORTGAGOR warrants and represents that the within described premises are improved by a ONE FAMILY RESIDENCE OR DWELLING ONLY.

RECEIVED 575.00  
RECORDING TAX

JAN 14 1981 BY 5316

SEAL [Signature] CLERK OF WESTCHESTER COUNTY

See Abs - Liber 15828 Pg 45

8222 733  
See Assignment Liber 15828 Pg 45  
" " 8336 " 235

50353

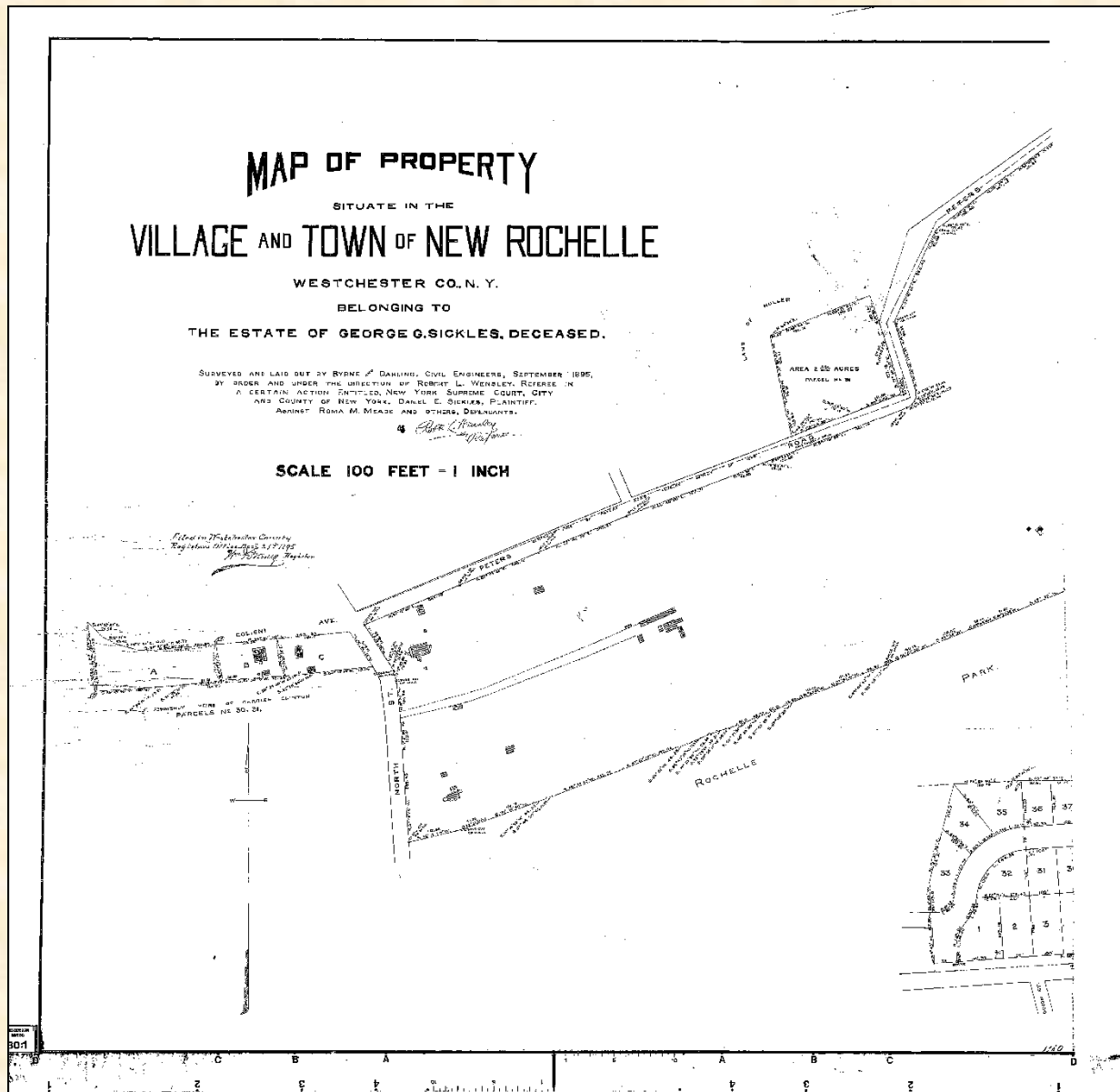

Sickles Property 1895



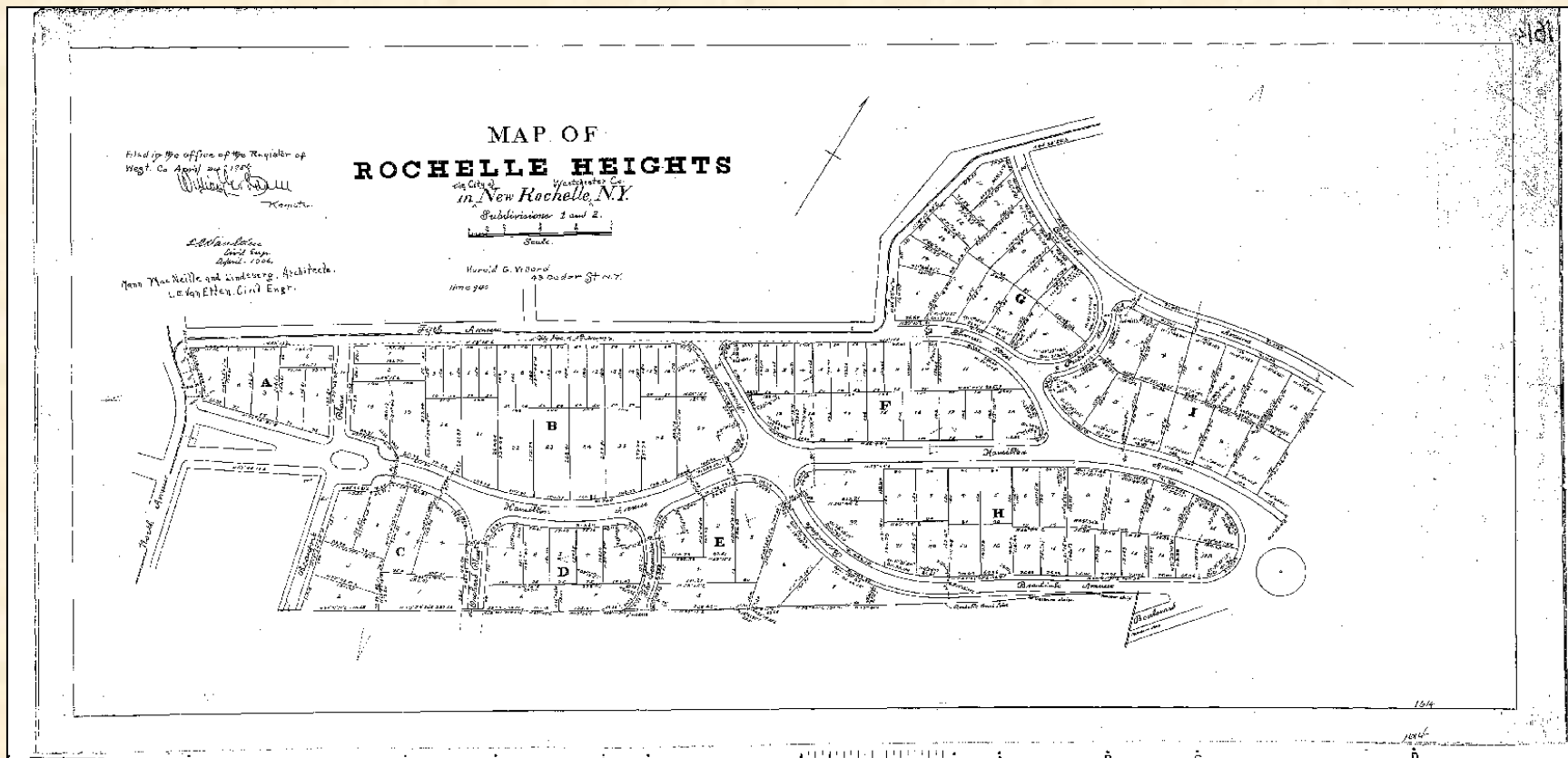

1905 Subdivision Map  
Mann, MacNeille and Lindeberg, Architects  
L. E. Van Etten, Civil Engineer

**Property Records & Much More**  
County Archives  
Westchester County Historical Society  
Located at the Westchester County Records Center, Elmsford

Deed Chain of Owners

Maps and Atlases

Subdivisions

Books (non-circulating)

Vertical Files

Past Perfect

Oddities







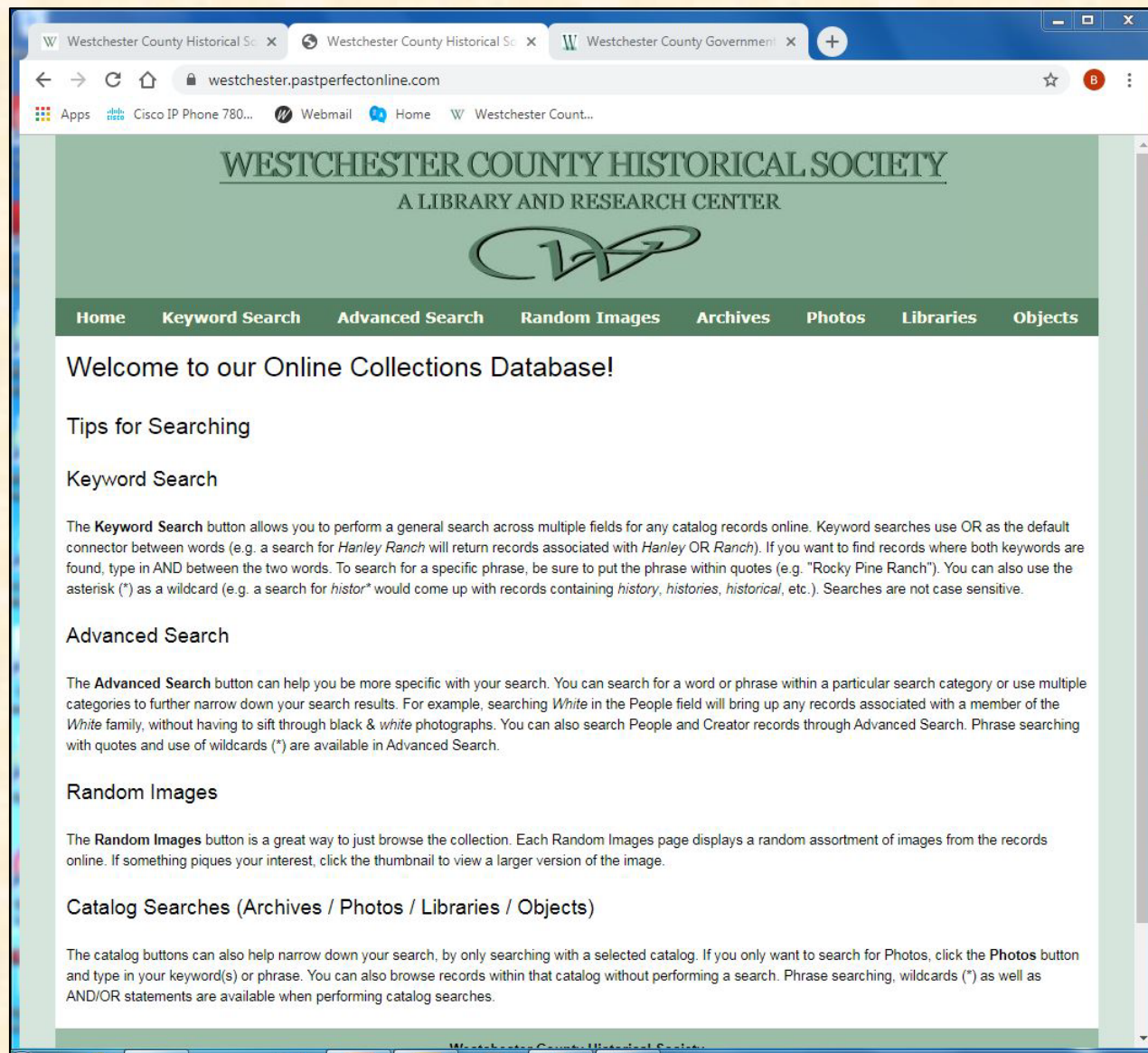

Westchesterhistory.com – Library – Online collections database  
Westchester.pastperfectonline.com





# WESTCHESTER COUNTY HISTORICAL SOCIETY

A LIBRARY AND RESEARCH CENTER

[Westchesterhistory.com](http://Westchesterhistory.com)

**Barbara Davis:**

[barbara@westchesterhistory.com](mailto:barbara@westchesterhistory.com)



Westchester  
gov.com

George Latimer  
Westchester County Executive

[archives@westchestergov.com](mailto:archives@westchestergov.com)



# New Rochelle Public Library

[www.nrpl.org](http://www.nrpl.org)

---

**Larry Sheldon**  
[Lsheldon@wlsmail.org](mailto:Lsheldon@wlsmail.org)